

Electrical Characteristics:  
 Current rating: 0.4A AC/DC  
 Voltage rating: 50V AC/DC  
 Temperature range: -25°C~+85°C  
 Withstand Voltage: 200V AC/Minute  
 Contact Resistance: 20m Ω  
 Insulation resistance: 500m Ω  
 Relative Humidity: 93%+40°C  
 Material Description:  
 Terminal: Phosphor Bronze  
 Fitting Nail: Brass  
 Housing: LCP(UL94V-0)  
 Slider: LCP(UL94V-0)

All materials must meet Greennon requirement for environment protection

| PIN数 | DIM-A | DIM-B | DIM-C | DIM-D | DIM-E |
|------|-------|-------|-------|-------|-------|
| 60P  | 35.6  | 34.5  | 29.50 | 30.60 |       |
| 59P  | 35.1  | 34.0  | 29.00 | 30.10 |       |
| 58P  | 34.6  | 33.5  | 28.50 | 29.60 |       |
| 57P  | 34.1  | 33.0  | 28.00 | 29.10 |       |
| 56P  | 33.6  | 32.5  | 27.50 | 28.60 |       |
| 55P  | 33.1  | 32.0  | 27.00 | 28.10 |       |
| 54P  | 32.6  | 31.5  | 26.50 | 27.60 |       |
| 53P  | 32.1  | 31.0  | 26.00 | 27.10 |       |
| 52P  | 31.6  | 30.5  | 25.50 | 26.60 |       |
| 51P  | 31.1  | 30.0  | 25.00 | 26.10 |       |
| 50P  | 30.6  | 29.5  | 24.50 | 25.60 |       |
| 49P  | 30.1  | 29.0  | 24.00 | 25.10 |       |
| 48P  | 29.6  | 28.5  | 23.50 | 24.60 |       |
| 47P  | 29.1  | 28.0  | 23.00 | 24.10 |       |
| 46P  | 28.6  | 27.5  | 22.50 | 23.60 |       |
| 45P  | 28.1  | 27.0  | 22.00 | 23.10 |       |
| 44P  | 27.6  | 26.5  | 21.50 | 22.60 |       |
| 43P  | 27.1  | 26.0  | 21.00 | 22.10 |       |
| 42P  | 26.6  | 25.5  | 20.50 | 21.60 |       |
| 41P  | 26.1  | 25.0  | 20.00 | 21.10 |       |
| 40P  | 25.6  | 24.5  | 19.50 | 20.60 |       |
| 39P  | 25.1  | 24.0  | 19.00 | 20.10 |       |
| 38P  | 24.6  | 23.5  | 18.50 | 19.60 |       |
| 37P  | 24.1  | 23.0  | 18.00 | 19.10 |       |
| 36P  | 23.6  | 22.5  | 17.50 | 18.60 |       |
| 35P  | 23.1  | 22.0  | 17.00 | 18.10 |       |
| 34P  | 22.6  | 21.5  | 16.50 | 17.60 |       |
| 33P  | 22.1  | 21.0  | 16.00 | 17.10 |       |
| 32P  | 21.6  | 20.5  | 15.50 | 16.60 |       |
| 31P  | 21.1  | 20.0  | 15.00 | 16.10 |       |
| 30P  | 20.6  | 19.5  | 14.50 | 15.60 |       |
| 29P  | 20.1  | 19.0  | 14.00 | 15.10 |       |
| 28P  | 19.6  | 18.5  | 13.50 | 14.60 |       |
| 27P  | 19.1  | 18.0  | 13.00 | 14.10 |       |
| 26P  | 18.6  | 17.5  | 12.50 | 13.60 |       |
| 25P  | 18.1  | 17.0  | 12.00 | 13.10 |       |
| 24P  | 17.6  | 16.5  | 11.50 | 12.60 |       |
| 23P  | 17.1  | 16.0  | 11.00 | 12.10 |       |
| 22P  | 16.6  | 15.5  | 10.50 | 11.60 |       |
| 21P  | 16.1  | 15.0  | 10.00 | 11.10 |       |
| 20P  | 15.6  | 14.5  | 9.50  | 10.60 |       |
| 19P  | 15.1  | 14.0  | 9.00  | 10.10 |       |
| 18P  | 14.6  | 13.5  | 8.50  | 9.60  |       |
| 17P  | 14.1  | 13.0  | 8.00  | 9.10  |       |
| 16P  | 13.6  | 12.5  | 7.50  | 8.60  |       |
| 15P  | 13.1  | 12.0  | 7.00  | 8.10  |       |
| 14P  | 12.6  | 11.5  | 6.50  | 7.60  |       |
| 13P  | 12.1  | 11.0  | 6.00  | 7.10  |       |
| 12P  | 11.6  | 10.5  | 5.50  | 6.60  |       |
| 11P  | 11.1  | 10.0  | 5.00  | 6.10  |       |
| 10P  | 10.6  | 9.5   | 4.50  | 5.60  |       |
| 9P   | 10.1  | 9.0   | 4.00  | 5.10  |       |
| 8P   | 9.6   | 8.5   | 3.50  | 4.60  |       |
| 7P   | 9.1   | 8.0   | 3.00  | 4.10  |       |
| 6P   | 8.6   | 7.5   | 2.50  | 3.60  |       |
| 5P   | 8.1   | 7.0   | 2.00  | 3.10  |       |
| 4P   | 7.6   | 6.5   | 1.50  | 2.60  |       |

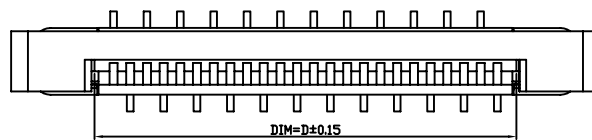
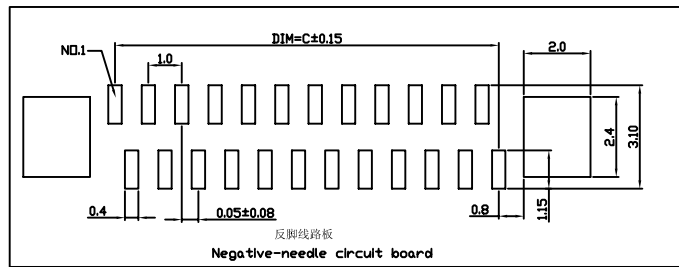
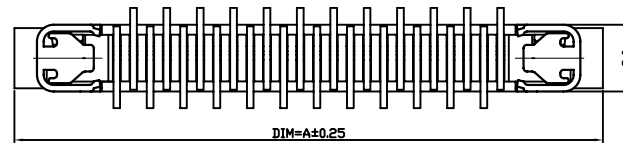
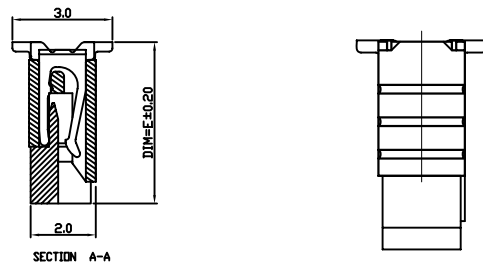

# Ordering Information

## FCZSVA1 - X 1 X X

Pins Of Per Row  
03~60

COLOR  
W=White  
I=Ivory

Select Packing  
T=TURE  
TR=Tape+Reel

|                                      |   |                |
|--------------------------------------|---|----------------|
| GENERAL TOLERANCE                    | ANGLE TOLERANCE                               | DESIGN DATE    |
| X. ± 0.38<br>.XX ±0.25<br>.XXX ±0.13 | X°. ±5°<br>.X° ±2°<br>.XX° ±1°<br>.XXX° ±0.5° | Andy2009.08.12 |
| UNIT:mm                              | SCALE 1:1                                     | CHECK DATE     |
| A4                                   | SHEET: 1 of 1                                 | APPRO. DATE    |

**All Connectors**  
 www.allconnectors.eu | info@allconnectors.eu  
 Tel. +49 (0)711 / 358 110 20 | Fax +49 (0)711 / 358 110 25

|             |                           |        |
|-------------|---------------------------|--------|
| FILE NAME   | 0.5 FPC Vertical SMT Type |        |
| PART NO     | FCZSVA1-X1XX              |        |
| DRAWING NO. | FCZSVA1-01                | REV.AO |