

Allconnectors 2.54mm FPC Socket Non ZIF Type

www.allconnectors.eu | info@allconnectors.eu
Tel. +49 (0)711 / 358 110 20 | Fax +49 (0)711 / 358 110 25

MATERIAL

Insulator : Polyester
Contact Pin : Phosphor Bronze

SPECIFICATION

Current Rate : 1 AMP
Insulation Resistance : 5000MΩMin.
Contact Resistance : 25mΩMax.
Operation Temperature : -40°C to +105°C



Detail Dimensions

979-11-2xx101

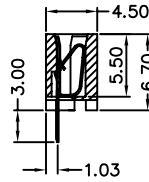
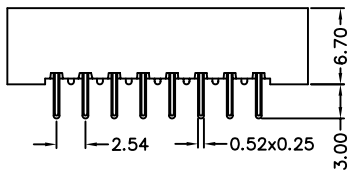
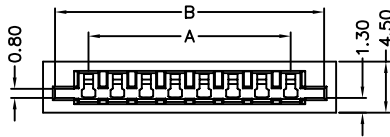

979-11-2xx301

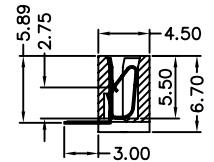
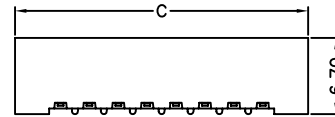
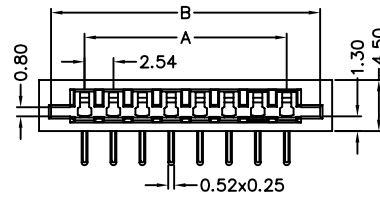

Recommended P.C.B Layout

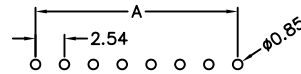
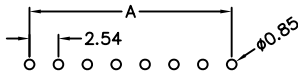

Order Information

979-11- 2 xx x 01
1 2

- No. of contacts (2~27)
- 1: Straight Type dual contacts
3: Right Angle Type dual contacts

Standard Parts
979-11-2xx101
979-11-2xx301

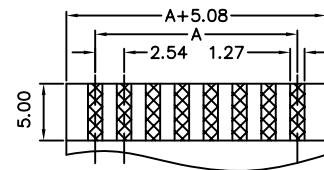

FPC/FFC T=0.30±0.05

Number Of Contacts

Unit: mm

Poles	DIM A	DIM B	DIM C	Poles	DIM A	DIM B	DIM C	Poles	DIM A	DIM B	DIM C	Poles	DIM A	DIM B	DIM C
2	2.54	8.43	10.54	9	20.32	26.21	28.32	16	38.10	43.99	46.10	23	55.88	61.77	63.88
3	5.08	10.97	13.08	10	22.86	28.75	30.86	17	40.64	46.53	48.64	24	58.42	64.31	66.42
4	7.62	13.51	15.62	11	25.40	31.29	33.40	18	43.18	49.07	51.18	25	60.96	66.85	68.96
5	10.16	16.05	18.16	12	27.94	33.83	35.94	19	45.72	51.60	53.72	26	63.50	69.39	71.50
6	12.70	18.59	20.70	13	30.48	36.37	38.48	20	48.26	54.15	56.26	27	66.04	71.93	74.04
7	15.24	21.13	23.24	14	33.02	38.91	41.02	21	50.80	56.69	58.80				
8	17.78	23.67	25.78	15	35.56	41.45	43.58	22	53.34	59.23	61.34				