

SECT A-A

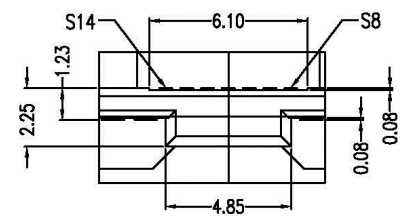

VIEW O
SCALE 3:1

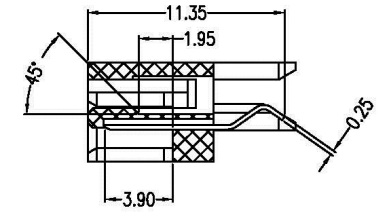
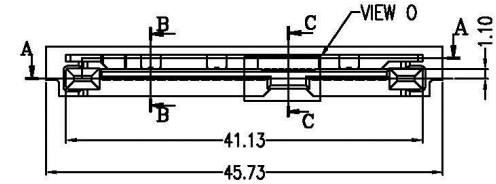

SECT B-B
SCALE 2:1

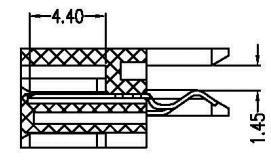
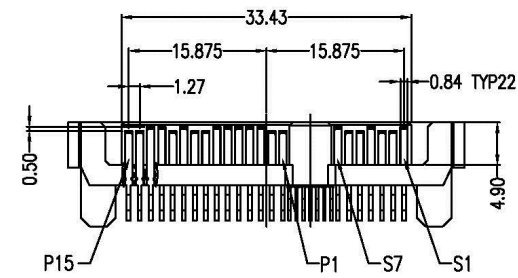

SECT C-C
SCALE 2:1

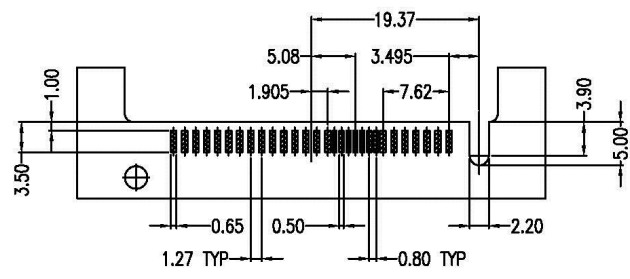

P.C.B LAYOUT (T=1.60mm)

NOTES:

***Material**
 Housing: LCP, UL 94V-0 rated, Color: Black;
 Contact: Brass;
 Plating: Gold plating over Nickel on contact area; Tin plating on solder tail.

***Mechanical**
 Insertion Force: 25N max.
 Withdrawal Force: 5N min.
 Durability: 500 cycles

***Electrical Specification**
 Current Rating: 1 Ampere per contact;
 Contact Resistance: 30 Milliohms max.
 Insulation Resistance: 1000 megohms min.
 Dielectric Withstanding Voltage: 500 V AC.

***Environmental**
 Operating Temperature: 0°C to +55°C

SAS-PEB-29-LF
 LEADFREE
 RoHS Compliant

All Connectors

www.allconnectors.de
 Tel.: 0049 711 7009503
 70794 Filderstadt - Germany

info@allconnectors.de
 Fax: 0049 711 7009504
 Kettenerstr. 25

PART NO. SAS-PEB-29

DWG NO. SAS-PEB-29

FILE NO.

UNIT / mm

CHECKED BY CY

DRAWING BY

SCALE 1:1

PROJECTION

TOLERANCES ARE

.X ± 0.2

.XX ±

.XXX ±
 AWG

DESCRIPTION:

SAS 29P Straddle
 Type(1.6) Male

AREA

REVISIONS

HK

DATE