

SECT A-A

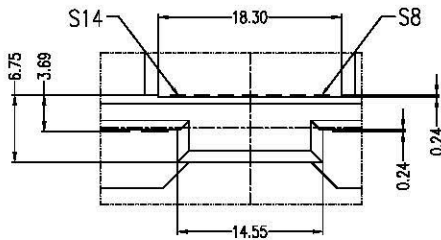

VIEW 0  
SCALE 3:1

Pin No.	Signal Segment	Type
P1	GND	
P2	A+	
P3	A+	
P4	GND	
P5	A+	
P6	GND	
P7	A+	
P8	GND	
P9	A+	
P10	GND	
P11	GND	
P12	A+	
P13	GND	
P14	GND	

Pin No.	Power Segment	Type
P1	V33	
P2	V33	
P3	V33	
P4	GND	
P5	V5	
P6	GND	
P7	V5	
P8	V5	
P9	V5	
P10	GND	
P11	DAS/DSS	
P12	GND	
P13	V12	
P14	V12	
P15	V12	

**NOTES:**

- Material:**  
Housing: LCP+50%G.F, UL 94V-0 Rated.  
Color: Black.  
Contact: Phosphor Bronze.  
Plating: Gold Plating over Nickel on Contact Area.  
Tin Plating on Solder Tail.
- Mechanical:**  
Insertion Force: 25N Max.  
Withdrawal Force: 5N Min.  
Durability: 500 Cycles
- Electrical Specification:**  
Current Rating: 1.5 Ampere per Contact.  
Contact Resistance: 30mΩ Max.  
Insulation Resistance: 1000MΩ Min.  
Dielectric Withstanding Voltage: 500 VAC.
- Environmental:**  
Operating Temperature: 0°C to +55°C

**Part Number:**

**CSAS-M29SS40-M4**

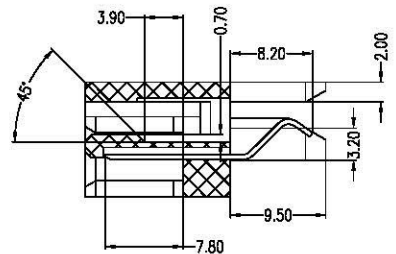
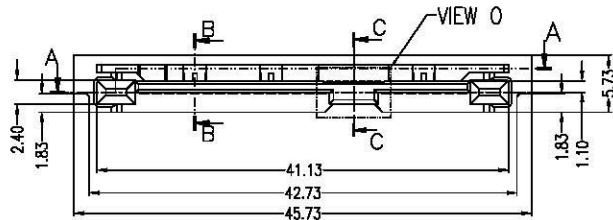
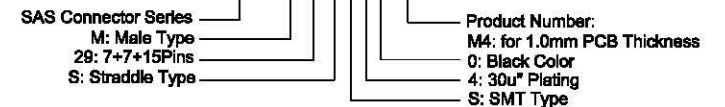

SECT B-B  
SCALE 2:1

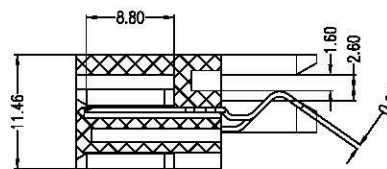
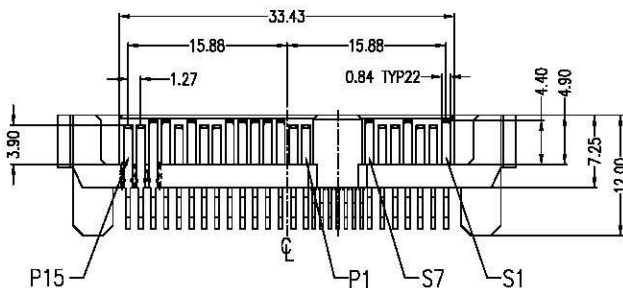

SECT C-C  
SCALE 2:1

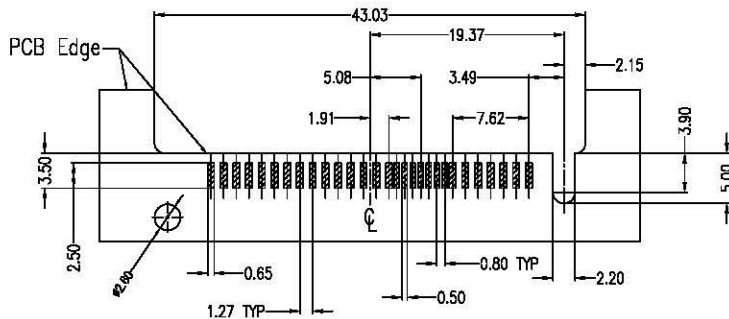

P.C.B LAYOUT (T=1.00mm)  
TOP VIEW

A	01/13/10	RELEASED FOR PRODUCTION	
REV	DATE	DESCRIPTION	
UNLESS OTHERWISE SPECIFIED, DIMENSIONS ARE IN MM. TOLERANCES ARE:			
DECIMALS	ANGLES	APPROVALS	DATE
X ± .38	± 3°	CHRIS	01/13/10
.XX ± .25		CHECKED	01/13/10
.XXX ± .20		APPV	01/13/10
DO NOT SCALE DRAWING		SHEET	DWG. NO.
		1 OF 1	CSAS-M29-M04
		SCALE	REV.
		NONE	A