

Signal Segment		Power Segment	
Pin NO.	Type	Pin NO.	Type
S1	GND	P1	V33
S2	A+	P2	V33
S3	A-	P3	V33
S4	GND	P4	GND
S5	B-	P5	GND
S6	B+	P6	GND
S7	GND	P7	V5
S8	A+	P8	V5
S9	A-	P9	V5
S10	A-	P10	GND
S11	GND	P11	DAS/DSS
S12	B-	P12	GND
S13	B+	P13	V12
S14	GND	P14	V12
		P15	V12

NOTES:

1. Material:

Housing: LCP+50%G.F, UL 94V-0 Rated.
 Color: Black.
 Contact: Phosphor Bronze.
 Plating: Gold Plating over Nickel on Contact Area.
 Tin Plating on Solder Tail.
 Harpoon: Phosphor Bronze.
 Plating: Tin Plating over Nickel.

2. Mechanical:

Insertion Force: 25N Max.
 Withdrawal Force: 5N Min.
 Durability: 500 Cycles

3. Electrical Specification:

Current Rating: 1.5 Ampere per Contact.
 Contact Resistance: 30mΩ Max.
 Insulation Resistance: 1000MΩ Min.
 Dielectric Withstanding Voltage: 500 VAC.

4. Environmental:

Operating Temperature: 0°C to +55°C

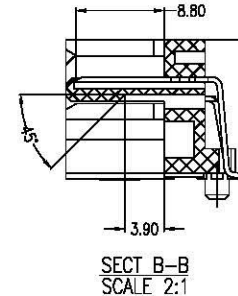
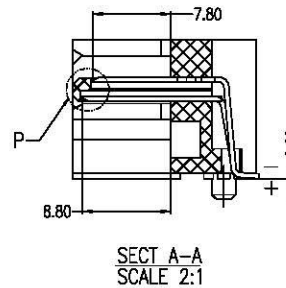
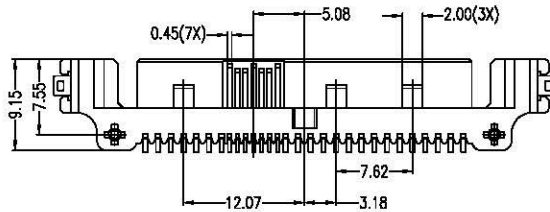
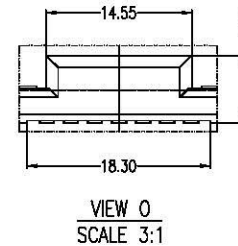
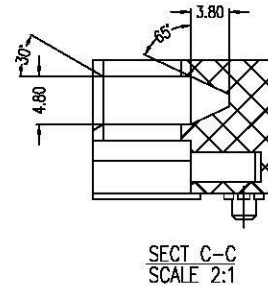
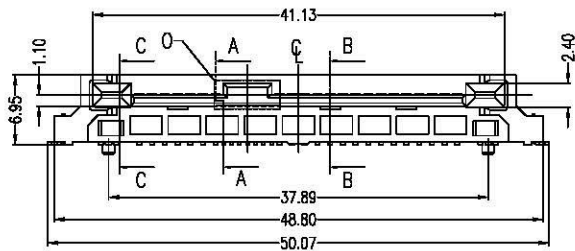

Part Number:

CSAS-M29RS40-M5

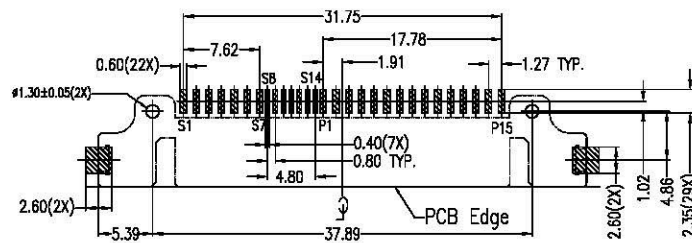
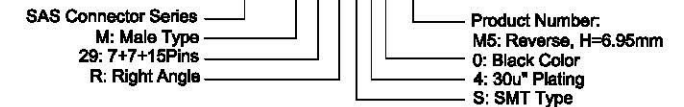

PCB LAYOUT
COMPONENT SIDE

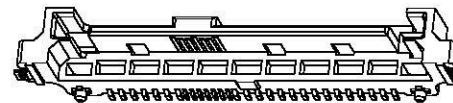

A		09/09/10		RELEASED FOR PRODUCTION	
REV	DATE	DESCRIPTION			
UNLESS OTHERWISE SPECIFIED, DIMENSIONS ARE IN MM. TOLERANCES ARE:		CAD GENERATED DRAWING, DO NOT MANUALLY UPDATE			
DECIMALS ANGLES		APPROVALS		DATE	
X ± .38	± 3°	DRAWN	Chris	09/09/10	
.XX ± .25		CHECKED	Chdy	09/09/10	
.XXX ± .20		APPV	Jason	09/09/10	
DO NOT SCALE DRAWING		SHEET 1 OF 1		SCALE NONE	
		DWG. NO.		CSAS-M29-M05	
		REV.		A	



www.allconnectors.de
 Tel.: 0049 711 7009503
 70724 Filderstadt - Germany
 info@allconnectors.de
 Fax: 0049 711 7009504
 Kettnerstr. 25

DESCRIPTION **SAS Connector, 7+7+15P Male, Right Angle Reverse Type, SMD, H=6.95mm Height**