

PCB LAYOUT(T=1.60mm)  
COMPONENT SIDE

Power Segment					Signal Segment			
Pin NO.	Type	Name	Type		Pin NO.	Type	Name	Type
P1	V33	P9	V5		S1	Signal Ground	S8	Signal Ground
P2	V33	P10	Ground		S2	TP+	S9	TS+
P3	V33	P11	Ready Lcd		S3	TP-	S10	TS-
P4	Ground	P12	Ground		S4	Signal Ground	S11	Signal Ground
P5	Ground	P13	V12		S5	RP-	S12	RS-
P6	Ground	P14	V12		S6	RP+	S13	RS+
P7	V5	P15	V12		S7	Signal Ground	S14	Signal Ground
P8	V5							

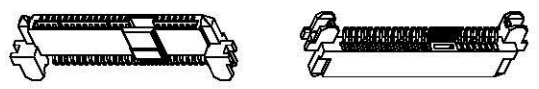
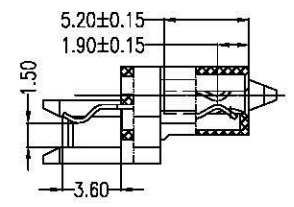
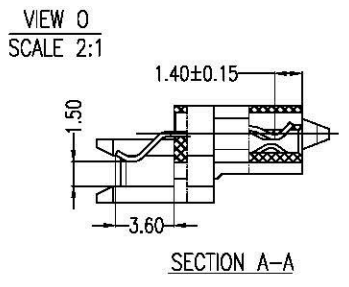
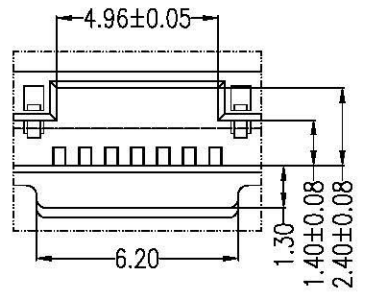

**NOTES:**

- Material:**  
Housing: LCP+50%G.F, UL 94V-0 Rated.  
Color: Black.  
Contact: Phosphor Bronze.  
Plating: Gold Plating over Nickel on Contact Area.  
Tin Plating on Solder Tail.
- Mechanical:**  
Insertion Force: 25N Max.  
Withdrawal Force: 5N Min.  
Durability: 500 Cycles
- Electrical Specification:**  
Current Rating: 1.5 Ampere per Contact.  
Contact Resistance: 30mΩ Max.  
Insulation Resistance: 1000MΩ Min.  
Dielectric Withstanding Voltage: 500 VAC.
- Environmental:**  
Operating Temperature: 0°C to +55°C

Part Number:

**CSAS-F29SS40-F4**

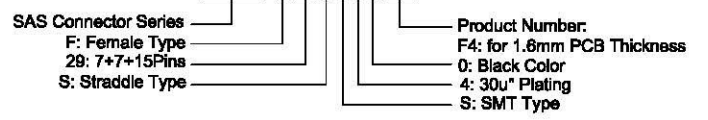

A		09/09/10		RELEASED FOR PRODUCTION		DESCRIPTION	
REV	DATE						
UNLESS OTHERWISE SPECIFIED DIMENSIONS ARE IN MM TOLERANCES ARE:		CAD GENERATED DRAWING, DO NOT MANUALLY UPDATE					
DECIMALS	ANGLES	APPROVALS	DATE				
X ± .38	± 3°	DRAWN	09/09/10	T: +49 711 7009503		F: +49 711 7009504	
.XX ± .25		CHECKED	09/09/10	70704 Fillearstadt - Germany		Kettestr. 25	
.XXX ± .20		APPV	09/09/10	DESCRIPTION <b>SAS Connector, 7+7+15P Female, Straddle SMD, for 1.6mm PCB Thickness</b>			
DO NOT SCALE DRAWING		SHEET	1 OF 1	SCALE	NONE	DWG. NO.	<b>CSAS-F29-F04</b>
						REV.	A