

PIN Signal Define	
PIN NO.	Signal Name
S1	GND
S2	A+
S3	A-
S4	GND
S5	B-
S6	B+
S7	GND

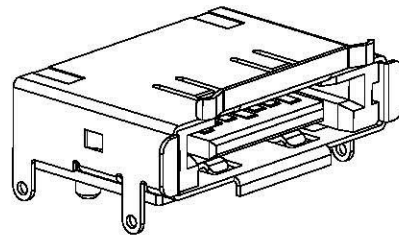
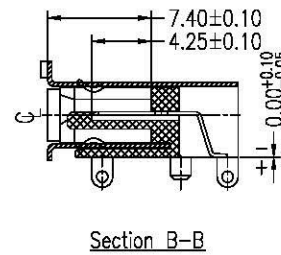
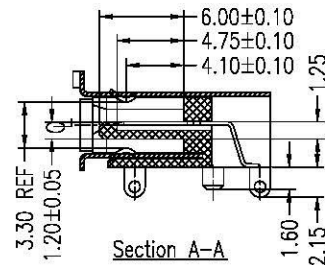
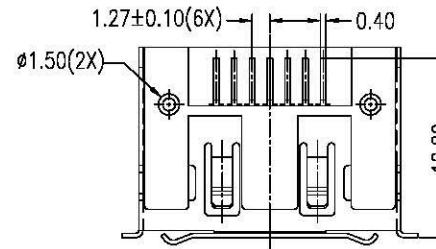
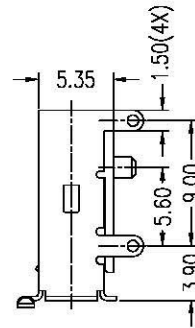

**NOTES:**

**1. Material:**

Housing: LCP+50%G.F, UL 94V-0 Rated.  
Color: Black.  
Contact: Brass.  
Plating: Gold Plating over Nickel on Contact Area.  
Tin Plating on Solder Tail.  
Shell: Brass.  
Plating: Ni(40u" Min) Plating.

**2. Mechanical:**

Insertion Force: 40N Max.  
Withdrawal Force: 10N Min.  
Durability: 2500 Cycles

**3. Electrical Specification:**

Operation Voltage: 100VAC Max.  
Current Rating: 1.5 Ampere per Contact.  
Contact Resistance: 30mΩ Max.  
Insulation Resistance: 1000MΩ Min.  
Dielectric Withstanding Voltage: 500 VAC.

**4. Environmental:**

Operating Temperature: -55°C to +85°C

**Part Number:**

**CEAT-M07RS30-B3**

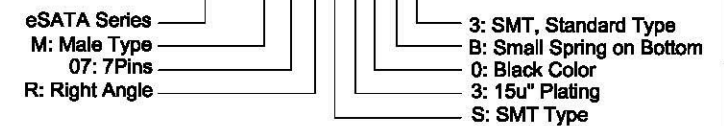

A	11/16/10	RELEASED FOR PRODUCTION	
REV	DATE	DESCRIPTION	
UNLESS OTHERWISE SPECIFIED, DIMENSIONS ARE IN MM. TOLERANCES ARE:			
DECIMALS	ANGLES	APPROVALS	DATE
X ± .38	± 3°	Chris	11/16/10
.XX ± .25		Checked	11/16/10
.XXX ± .20		APPV	Jason
DO NOT SCALE DRAWING	SHEET 1 OF 1	SCALE NONE	DWG. NO. CEAT-M07-S02
		www.allconnectors.de Tel: 0049 713 7093503 70794 Filderstadt, Germany Info@allconnectors.de Fax: 0049 713 7092504 Kottbusstr. 25	
		DESCRIPTION <b>eSATA 7P, Male, Right Angle, Standard SMT, Small Spring on Bottom</b>	
		REV. A	