

Signal Pin assignments Table

Pin	Signal Assignment	Pin	Signal Assignment	Pin	Signal Assignment
1	T.M.D.S.Data2-	9	T.M.D.S.Data1-	17	T.M.D.S.Data0-
2	T.M.D.S.Data2+	10	T.M.D.S.Data1+	18	T.M.D.S.Data0+
3	T.M.D.S.Data2/4 Shield	11	T.M.D.S.Data1/3 Shield	19	T.M.D.S.Data0/5 Shield
4	T.M.D.S.Data4-	12	T.M.D.S.Data3-	20	T.M.D.S.Data5-
5	T.M.D.S.Data4+	13	T.M.D.S.Data3+	21	T.M.D.S.Data5+
8	DDC Clock	14	+5V Power	22	T.M.D.S.Clock Shield
7	DDC Data	15	Ground(return for +5V, HSync, and Vsync)	23	T.M.D.S.Clock+
8	Analog Vertical Sync	16	Hot Plug Detect	24	T.M.D.S.Clock-
C1	Analog Red	C2	Analog Green	C3	Analog Blue
C4	Analog Horizontal Sync	C5	Analog Green (analog R,G,&B return)		

NOTES:

1. Material:

Body: Nylon66+30%G.F, UL 94V-0 Rated.
 Color: White.
 Latch: Nylon66+30%G.F, UL 94V-0 Rated.
 Color: White.
 Contact: Brass.
 Plating: Gold Plating over Nickel on Contact Area.
 Tin Plating on Solder Tail.
 Shell: SPCC.
 Plating: Full Nickel Plating.

2. Mechanical:

Mating Force: 4.5Kg Max @ 25mm/Munite.
 Unmating Force: 1.0Kg Min and 4.0Kg Max @ 25mm/Munite.
 Durability: 100 Cycles

3. Electrical Specification:

Current Rating: 1.5 Ampere per Contact.
 Shell Resistance: 50mΩ Max Initial, 50mΩ Max.
 Contact Resistance: 20mΩ Max.
 Insulation Resistance: 1000MΩ Min.
 Dielectric Withstanding Voltage: 500V DC RMS ± 50V, 60 HZ.

4. Environmental:

Operating Temperature: -20°C to +85°C

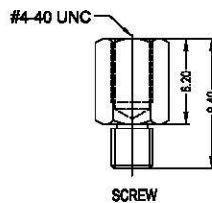
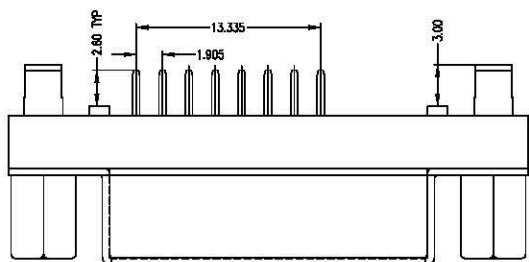
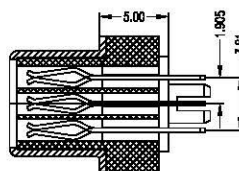
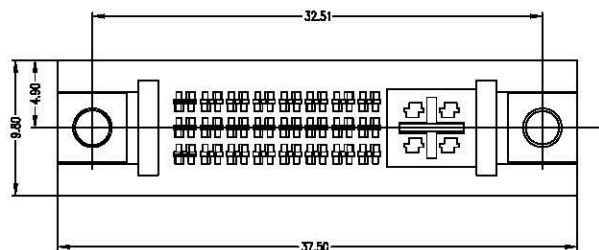

Part Number:

CDVI- F24VDG1-I1

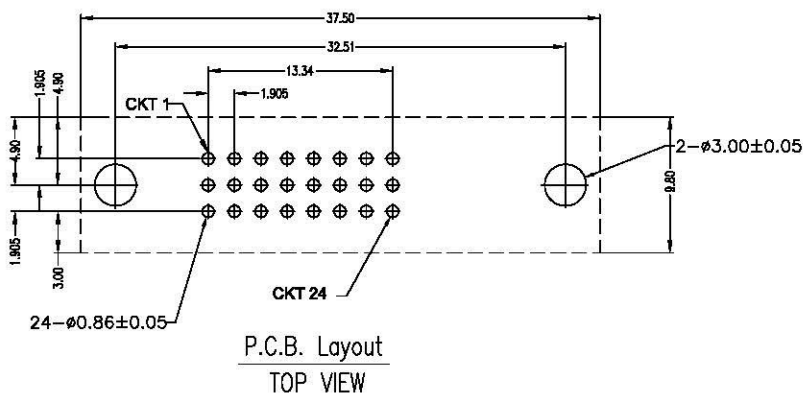
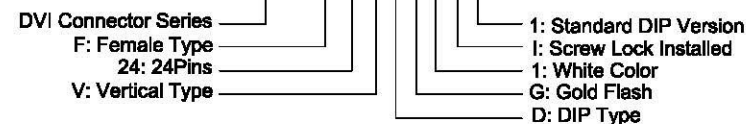

A	06/29/09	RELEASED FOR PRODUCTION	
REV	DATE	DESCRIPTION	
UNLESS OTHERWISE SPECIFIED, DIMENSIONS ARE IN MM TOLERANCES ARE:		<p>www.allconnectors.com info@allconnectors.com TEL: 907-711-7000 FAX: 907-711-7000 70701 BILMEDI - GERMANY BILMEDI-25</p>	
DECIMALS ANGLES			
X ± .38 ± 3°			
.XX ± .25			
.XXX ± .20		DESCRIPTION	
DO NOT SCALE DRAWING		DVI-I Connector, 24Pins, Female Type Vertical, DIP=2.60mm, Screw Lock Installed	
SHEET	1 OF 1	SCALE	NONE
DWG. NO.		CDVI-F29-VI1	
REV.		A	