

SPECIFICATIONS:

1. CURRENT CARRYING CAPACITY : PIN NO. A & B : 20 VDC 7.5A MAX .
PIN NO. C : 20 VDC 1A MAX .
2. DIELECTRIC STRENGTH : A POTENTIAL OF 250V RMS , 50/60 HZ SHALL BE APPLIED BETWEEN ANY OPEN CONTACTS , FOR 1 MINUTE , WITHOUT BREAKDOWN .
3. INSULATION RESISTANCE : BEFORE ANY ENVIRONMENTAL TEST : 50 MOHM MIN . @250 VDC
AFTER ANY ENVIRONMENTAL TEST : 5 MOHM MIN . @250 VDC
4. CONTACT RESISTANCE : BEFORE ANY TEST
PIN TO CNTACTOR NO. A,B&C : 30mOHM MAX . @20 mA ,1 KHZ
AFTER PERFORMANCE LIFE TEST
PIN TO CNTACTOR NO. A&B : 60mOHM MAX . @20 mA ,1 KHZ
PIN TO CNTACTOR NO. C : 100mOHM MAX . @20 mA ,1 KHZ
5. INSERTION FORCE AND WITHDRAWAL FORCE : INSERTION FORCE : 6.0KG MAX .
WITHDRAWAL FORCE : 0.5 - 6.0 KG
6. PERFORMANCE TEST (NO LOAD CONDITION) : SOCKETS SHALL BE SUBJECT TO 1,000 CYCLES,
AT THE RATE OF 10 TO 20 CYCLES PER MINUTE .
7. UNLESS OTHER SPECIFIC, TOLERANCE IS ±0.2

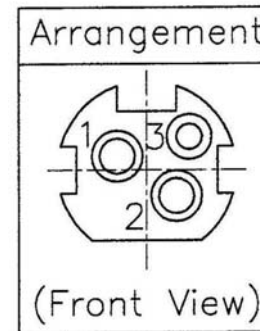

6	Shield	SPCC	tin ptd.
5	C. terminal	PBR-H	tin ptd.
4	A. B. terminal	BSR-H	tin ptd.
3	Earth Terminal	BSR-H	tin ptd.
2	Cover	P.B.T.	
1	Body	P.B.T.	
Item	Description	Material	Treat

RoHS
LEAD FREE
TOLERANCE .X±0.25 .XX±0.10

All Connectors

www.allconnectors.eu | info@allconnectors.eu
Tel. +49 (0)711 / 358 110 20 | Fax +49 (0)711 / 358 110 25

DATE	02-06-09	PART NO.	A001-3SS
DWN	GINA	REV.	0
CHK	KATY		
UNIT	MM		
ITEM	Circular Power Connector Push Lock Type		

NOTE: REV.0 NEW

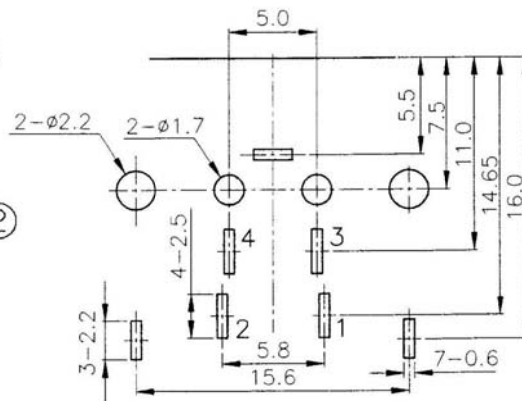
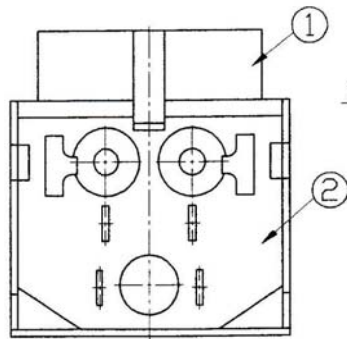
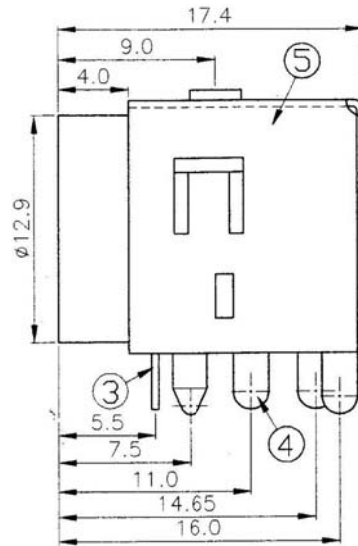
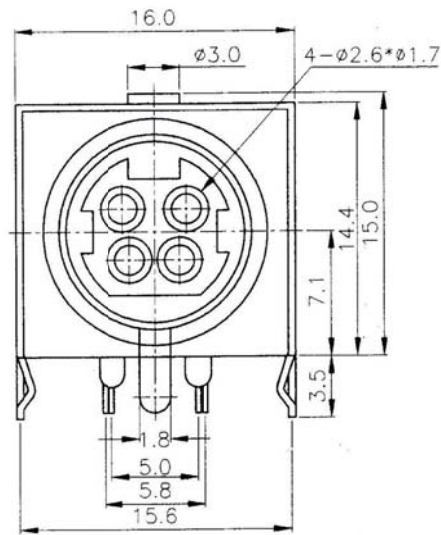

PCB LAYOUT
TOP VIEW

SPECIFICATIONS:

1. CURRENT CARRYING CAPACITY: 20VDC 7.5A MAX.
2. DIELECTRIC STRENGTH: A POTENTIAL OF 250V RMS, 50/60HZ SHALL BE APPLIED BETWEEN ANY OPEN CONTACTS, FOR 1 MINUTE, WITHOUT BREAKDOWN.
3. INSULATION RESISTANCE: BEFORE ANY ENVIRONMENTAL TEST: 50M OHM MIN. @250VDC. AFTER ANY ENVIRONMENTAL TEST: 5M OHM MIN. @250VDC.
4. CONTACT RESISTANCE: BEFORE ANY TEST: 30m OHM MAX. @20 mA, 1 KHZ. AFTER PERFORMANCE LIFE TEST: 60m OHM MAX. @20mA, 1KHZ.
5. INSERTION FORCE AND WITHDRAWAL FORCE:
INSERTION FORCE: 6.0KG MAX.
WITHDRAWAL FORCE: 0.5 - 6.0KG.
6. PERFORMANCE TEST (NO LOAD CONDITION): SOCKETS SHALL BE SUBJECT TO 1,000 CYCLES, AT THE RATE OF 10 TO 20 CYCLES PER MINUTE.
7. UNLESS OTHER SPECIFIC, TOLERANCE IS ± 0.2

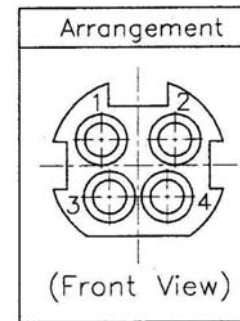

5	Shield	SPCC	tin ptd.
4	Contact terminal	BSR-H	tin ptd.
3	Earth Terminal	BSR-H	tin ptd.
2	Cover	P.B.T.	
1	Body	P.B.T.	
Item	Description	Material	Treat

RoHS
LEAD FREE
TOLERANCE .X ± 0.25 .XX ± 0.10

All Connectors

www.allconnectors.eu | info@allconnectors.eu
Tel. +49 (0)711 / 358 110 20 | Fax +49 (0)711 / 358 110 25

DATE

03-24-09

PART NO.

A001-4SS

DWN

GINA

REV.

0

CHK

KATY

ITEM

Circular Power Connector Push Lock Type

UNIT

MM

NOTE: REV.0 NEW