

### Specification

1. Current carrying capacity: Large Pin 20V DC 7.5A max.  
Small Pin 20V DC 1A max.
2. Contact resistance: Large Pin 30mΩ max.  
Small Pin 50mΩ max.
3. Insulation resistance: DC 250V 50MΩ min.
4. Voltage withstand: AC 250V / 1 minute
5. Insertion force: 3.5kgs max.
6. Withdrawal force: 0.5-2.5Kgs

RoHS  
LEAD FREE  
TOLERANCE .X±0.25 .XX±0.10

5	Nut	Iron	nickel ptd.
4	Terminal	Brass	tin ptd.
3	Housing	P.B.T.	
2	Shell	Brass	nickel ptd.
1	Body	PP	
Item	Description	Material	Treat

# Allconnectors

www.allconnectors.eu | info@allconnectors.eu  
Tel. +49 (0)711 / 358 110 20 | Fax +49 (0)711 / 358 110 25

ITEM	Circular Power Connector Push Lock Type	DATE	10-22-2010	PART NO.	A001-3SPM
		DWN	GINA	REV.	0
		CHK	KATY		
		UNIT	MM		

NOTE: REV.0 NEW

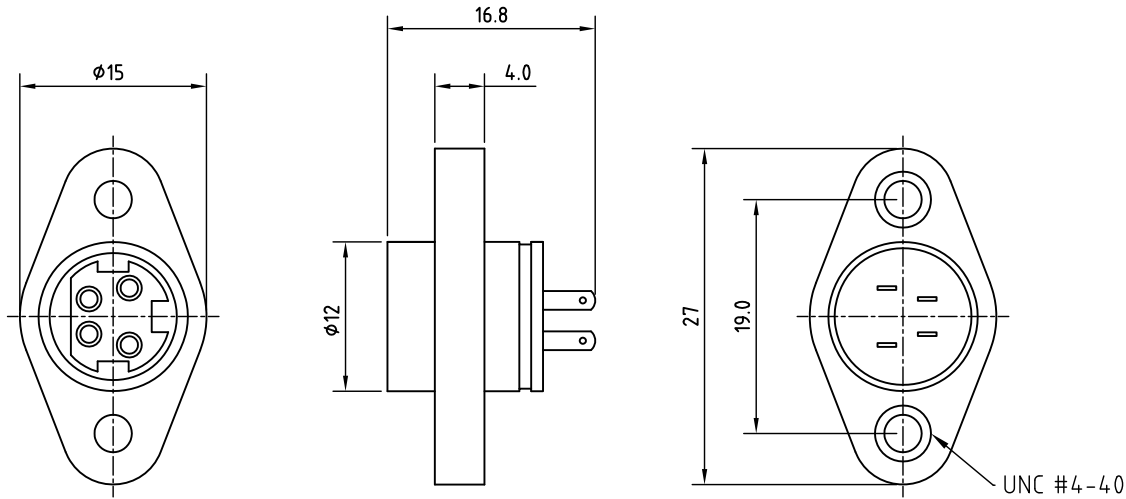

### Specification

1. Current carrying capacity: Large Pin 20V DC 7.5A max.  
Small Pin 20V DC 1A max.
2. Contact resistance: Large Pin 30mΩ max.  
Small Pin 50mΩ max.
3. Insulation resistance: DC 250V 50MΩ min.
4. Voltage withstand: AC 250V / 1 minute
5. Insertion force: 3.5kgs max.
6. Withdrawal force: 0.5-2.5Kgs

RoHS  
LEAD FREE  
TOLERANCE .X±0.25 .XX±0.10

5	Nut	Iron	nickel ptd.
4	Terminal	Brass	tin ptd.
3	Housing	P.B.T.	
2	Shell	Brass	nickel ptd.
1	Body	PP	
Item	Description	Material	Treat

**Allconnectors**

www.allconnectors.eu | info@allconnectors.eu  
Tel. +49 (0)711 / 358 110 20 | Fax +49 (0)711 / 358 110 25

DATE	10-22-2010	PART NO.	A001-4SPM
DWN	GINA	REV.	0
CHK	KATY		
ITEM	Circular Power Connector Push Lock Type	UNIT	MM

NOTE: REV.0 NEW