

SWITCH CIRCUIT

MATERIAL AND FINISH AS BELOW

WHEN CARD IS EJECTED

WHEN CARD IS INSERTED

A	Housing	LCP UL94V-0 Black	E
B	Contact	Phosphor Bronze C5210, Contact Area: Gold Flash	F
C	Latch	Stainless Steel SUS301	G
D			H

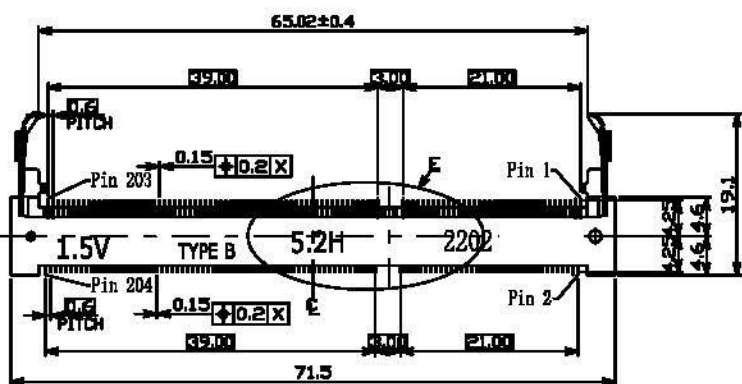
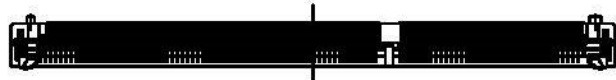

NOTES:

DATE CODE 2202 (YWW)
 Y: 2 YEAR(2012)
 WW:20 WEEK(01~52)
 D: 2 DAY(01~07)

SPECIFICATION:

- ELECTRICAL**
 - 1.1 Current Rating: 0.5A per pin
 - 1.2 Voltage Rating: 25V AC/DC
 - 1.3 Contact Resistance: 60mΩ
 - 1.4 Insulation Resistance: 500MΩ
 - 1.5 Dielectric Withstanding Voltage: 125VAC

- MECHANICAL**
 - 2.1 Durability: 25 Cycle
 - 2.2 Latch Retention Force: 8 N/Pos. Min

- ENVIRONMENTAL**
 - 3.1 Operating temperature range: -40°C~+85°C
 - 3.2 Storage temperature range: -40°C~+85°C

- SOLDER ABILITY**
 - 4.1 Recommended IR Reflow Temperature: 255°C 10Sec

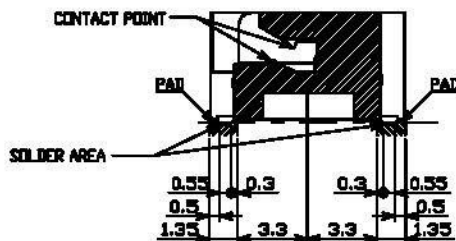
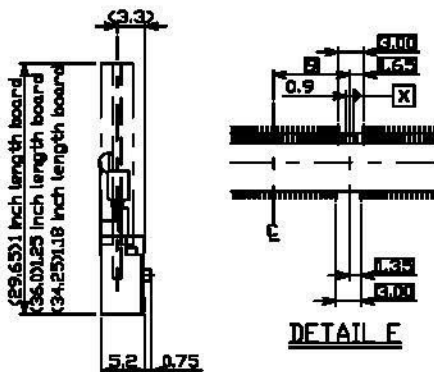

P1	P2	P3	P4	P5	P6	P7	P8	P9	P10	P11	P12
----	----	----	----	----	----	----	----	----	-----	-----	-----

PIN ASSIGNMENT

122A-52A10 SO DIMM DDR3 Socket 1.5V 204Pin Reverse Type 5.2H, Contact Area: Gold Flash

PRODUCT NO. DESCRIPTION

UNLESS OTHERWISE SPECIFIED TOLERANCE

ANGLES	ANG.	±5°
LINEAR	0.	±0.25
	0.00	±0.20

SCALE AS SHOWN UNIT: mm

DRAWN Willis 2012/12/05

CHECKED Angel 2012/12/05

APPROVED Ken 2012/12/05



www.allconnectors.de
 Tel: +49 71 709940
 70799 Filderstadt, Germany
 info@allconnectors.de
 Fax: +49 71 709942
 Wellenringstr. 25

DRAWN NAME: SO DIMM DDR3 Socket 1.5V 204Pin 5.2H Reverse Type

PRODUCT NO. 122A-52A10

FILE NAME 122A-52A10_B_1

- △ Revise:
- △ Revise:
- △ Revise:

REV.	DESCRIPTION	DATE	REV.	DESCRIPTION	DATE	SIZE	REV.	FILE NAME
1						A4	1.0	122A-52A10_B_1

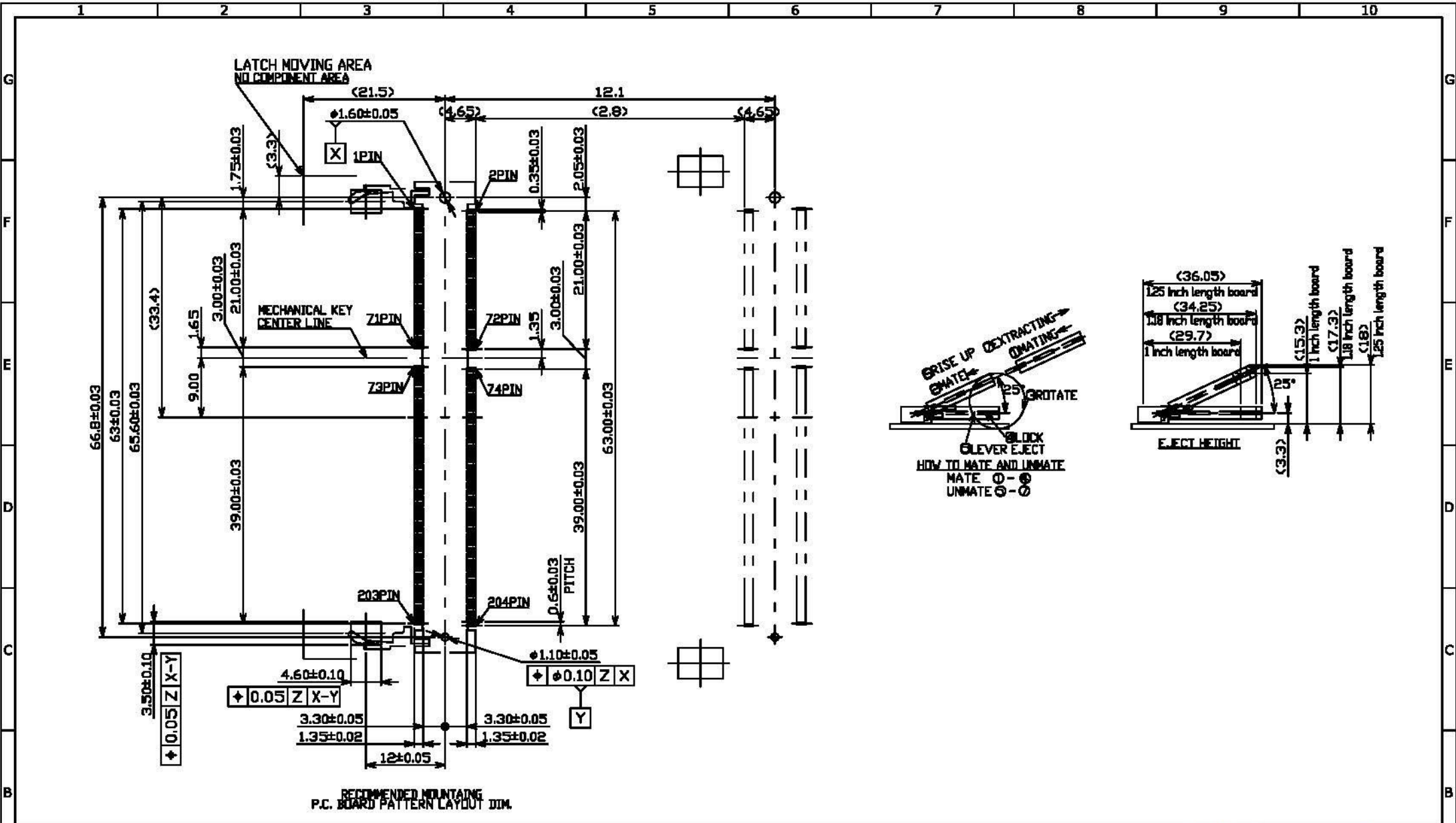

REV.	DESCRIPTION	DATE	REV.	DESCRIPTION	DATE
1			1		
2			2		
3			3		
4			4		
5			5		
6			6		
7			7		
8			8		
9			9		
10			10		

UNLESS OTHERWISE SPECIFIED TOLERANCE		
ANGLES	ANG.	±0.3
LINEAR	0.	±0.25
	0.00	±0.20
SCALE	AS SHOWN	UNIT: mm
DRAWN	Willis	2012/12/05
CHECKED	Angel	2012/12/05
APPROVED	Ken	2012/12/05

		www.allconnectors.de info@allconnectors.de Tel: +0049 7141 7005503 Fax: +0049 7141 7005504 · 70724 Filderstadt · Germany www.allconnectors.de	
		DRAWN NAME: SO DIMM DDR3 Socket 1.5V 204Pin 5.2H Reverse Type	PRODUCT NO.: 122A-52A10
REV. 1.0		FILE NAME: 122A-52A10_B_1	

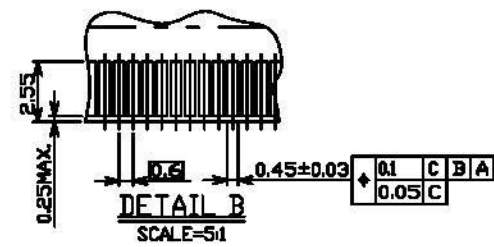
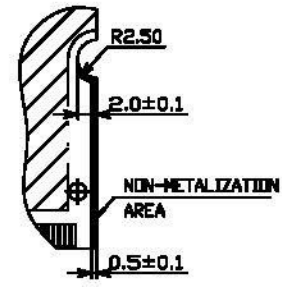
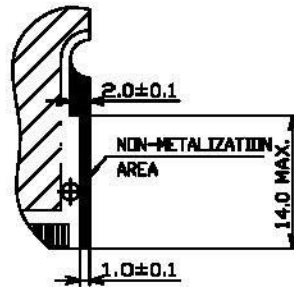
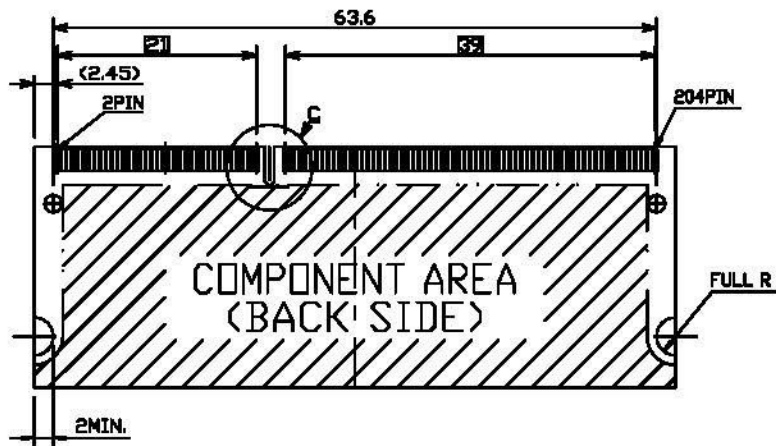
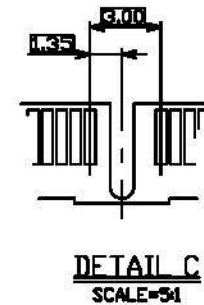
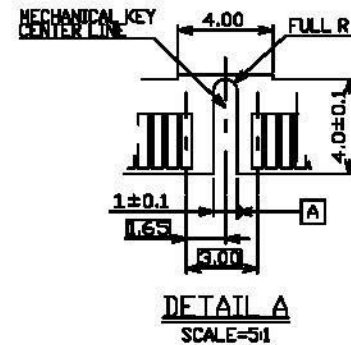
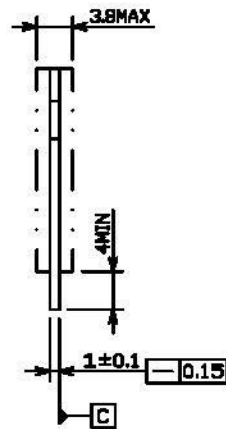
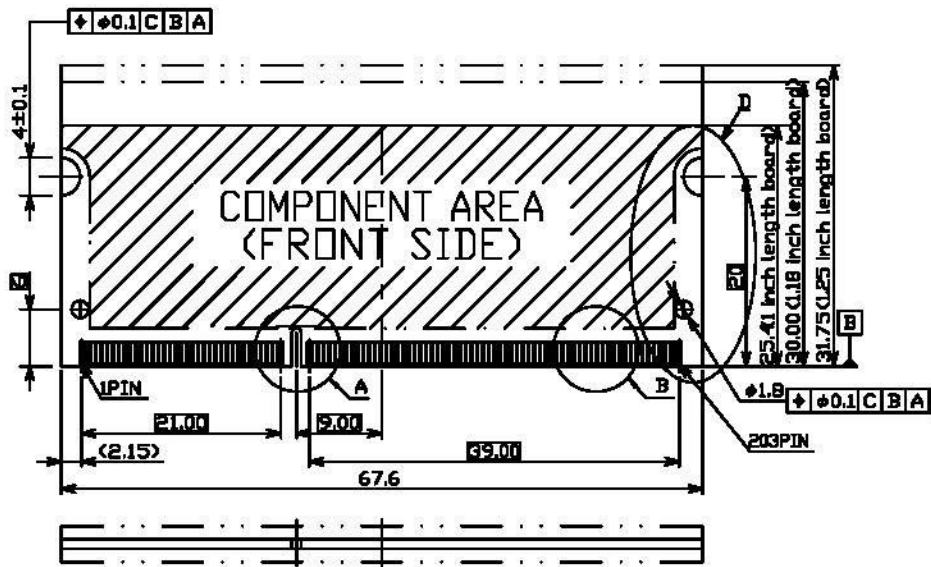

RECOMMENDED MATING
P.C. BOARD DIM.

						UNLESS OTHERWISE SPECIFIED TOLERANCE				
						ANGLES	ANG.	±5°		
						LINEAR	0.	±0.3	www.allconnectors.de info@allconnectors.de TEL: 0049 331 200000 70794 Filderstadt, Germany Filderstadt, DE	
							0.00	±0.20		
						SCALE	AS SHOWN	UNIT: mm	DRAWN NAME: SO DIMM DDR3 Socket 1.5V 204Pin 5.2H Reverse Type	
						DRAWN	Willis	2012/12/05		
						CHECKED	Angel	2012/12/05		
						APPROVED	Ken	2012/12/05		
						PRODUCT NO.	122A-52A10		FILE NAME: 122A-52A10_B_1	
						REV.	1.0			
REV.	DESCRIPTION		DATE	REV.	DESCRIPTION		DATE	SIZE	MM	REV.
1				4						

- △ Revise:
- △ Revise:
- △ Revise:

PACKAGING SPECIFICATION:

1. PACKING

- 1.1 Quantity:**
- 20 Piece/Tray**
- 220 Piece/Inner Carton**
- 660 Piece/Outer Carton**

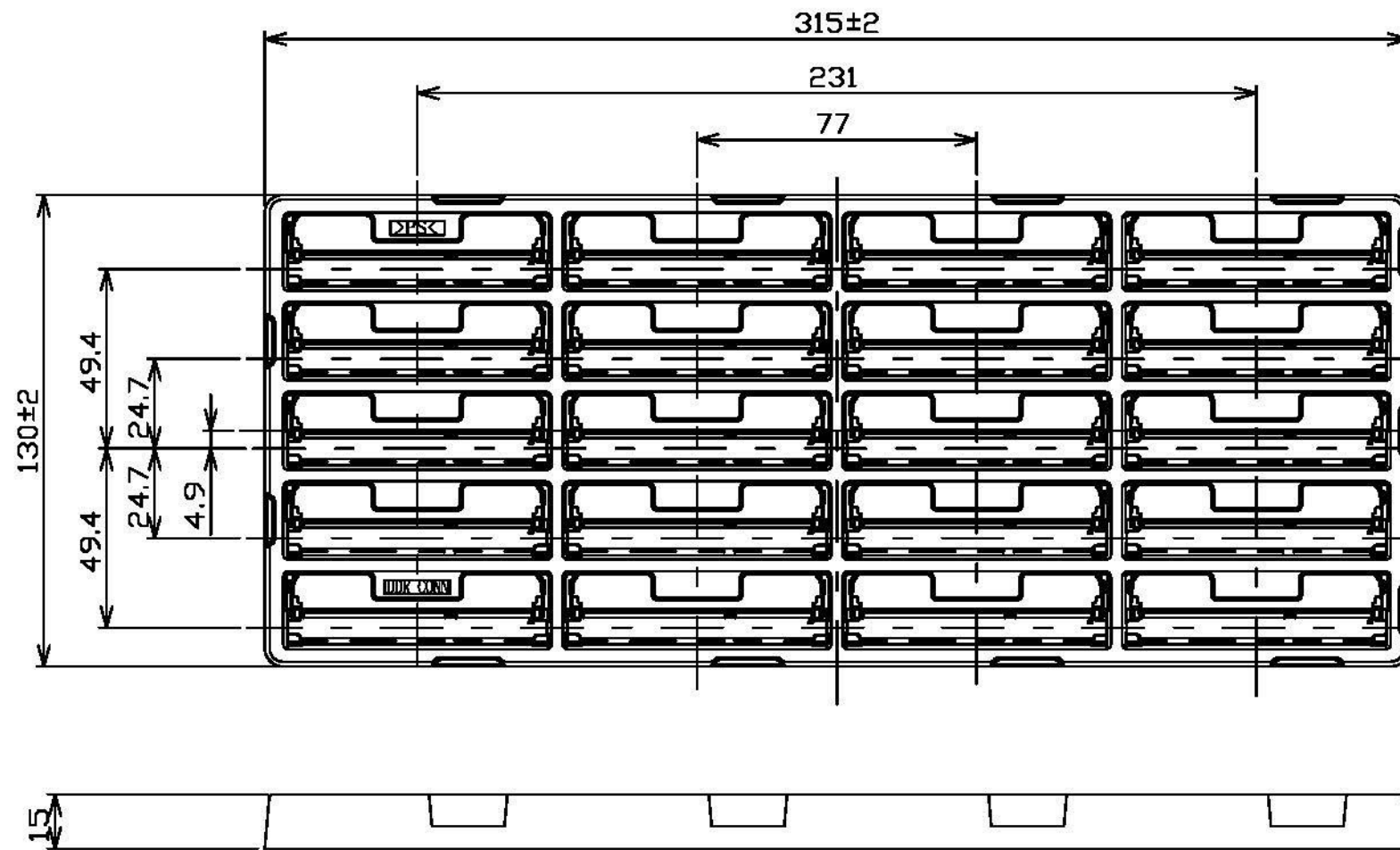

SOFT TRAY PACKAGING

UNLESS OTHERWISE SPECIFIED TOLERANCE		
ANGLES	ANG.	±5°
	0.	±0.3
LINEAR	D.0	±0.25
	0.00	±0.20
SCALE	AS SHOWN	UNIT: mm
DRAWN	Willis	2012/12/05
CHECKED	Angel	2012/12/05
APPROVED	Ken	2012/12/05

All Connectors

www.allconnectors.de info@allconnectors.de
 Tel: 0049 71 7002500 Fax: 0049 71 7002504
 70796 Filderstadt - Germany Kellerestr. 25

DRAWN NAME:
 SO DIMM DDR3 Socket
 1.5V 204Pin 5.2H Reverse Type

PRODUCT NO.: 122A-52A10
FILE NAME: 122A-52A10_D_1

REV.	DESCRIPTION	DATE	REV.	DESCRIPTION	DATE
1			4		
2			5		
3			6		

- △ Revise:
- △ Revise:
- △ Revise:

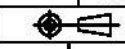

SIZE A4 REV. 1.0