

SWITCH CIRCUIT

MATERIAL AND FINISH AS BELOW

WHEN CARD IS EJECTED

WHEN CARD IS INSERTED

A	Housing	LCP UL94V-0 Black	E
B	Contact	Phosphor Bronze C5210, Contact Area: Gold Flash	F
C	Latch	Stainless Steel SUS301	G
D			H

NOTES:  
 DATE CODE 2202 (YWWD)  
 Y: 2 YEAR(2012)  
 WW:20 WEEK(01~52)  
 D: 2 DAY(01~07)

**SPECIFICATION:**

- ELECTRICAL**
  - 1.1 Current Rating: 0.5A per pin
  - 1.2 Voltage Rating: 25V AC/DC
  - 1.3 Contact Resistance: 60mΩ
  - 1.4 Insulation Resistance: 500MΩ
  - 1.5 Dielectric Withstanding Voltage: 125VAC

- MECHANICAL**
  - 2.1 Durability: 25 Cycle
  - 2.2 Latch Retention Force: 8 N/Pos. Min

- ENVIRONMENTAL**
  - 3.1 Operating temperature range: -40°C~+85°C
  - 3.2 Storage temperature range: -40°C~+85°C

- SOLDER ABILITY**
  - 4.1 Recommended IR Reflow Temperature: 255°C 10Sec

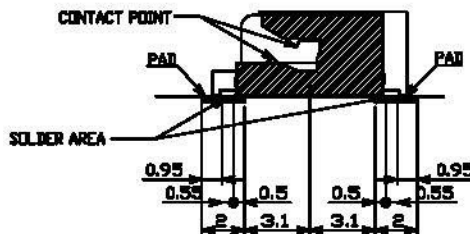
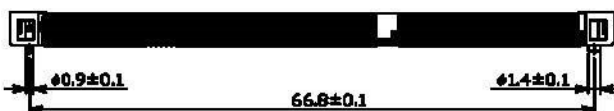
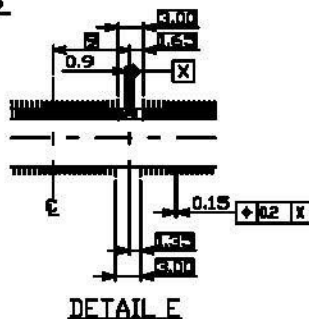
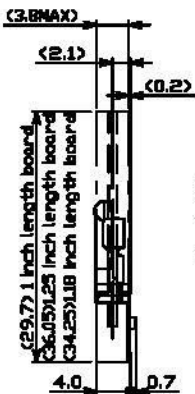
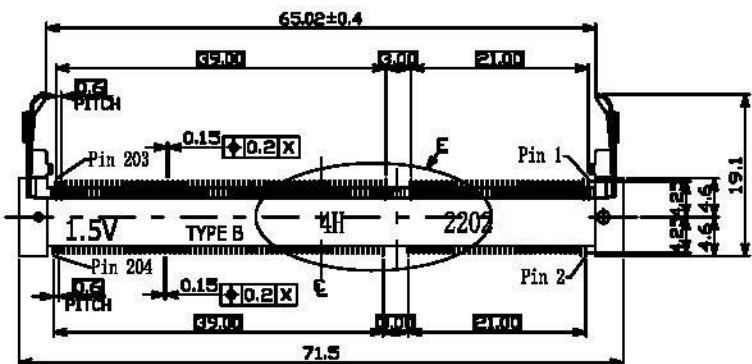

P1	P2	P3	P4	P5	P6	P7	P8	P9	P10	P11	P12
----	----	----	----	----	----	----	----	----	-----	-----	-----

PIN ASSIGNMENT

122A-40A10 SO DIMM DDR3 Socket 1.5V 204Pin Reverse Type 4.0H, Contact Area: Gold Flash

PRODUCT NO. DESCRIPTION

UNLESS OTHERWISE SPECIFIED TOLERANCE

ANGLES	ANG.	±SP
LINEAR	0.	±0.3
	0.0	±0.25
	0.00	±0.20
SCALE	AS SHOWN	UNIT: mm
DRAWN	Willis	2012/12/05
CHECKED	Angel	2012/12/05
APPROVED	Ken	2012/12/05

**All Connectors**

www.allconnectors.de  
 Tel.: 0049 711 7003803  
 70794 Nieferstedt - Germany  
 info@allconnectors.de  
 Fax: 0049 711 7003804  
 kettemestr. 15

DRAWN NAME: SO DIMM DDR3 Socket 1.5V 204Pin 4.0H Reverse Type

PRODUCT NO. 122A-40A10

- △ Revise:
- △ Revise:
- △ Revise:

REV.	DESCRIPTION	DATE	REV.	DESCRIPTION	DATE	SIZE	REV.	FILE NAME
1						A4	1.0	122A-40A10_B_1

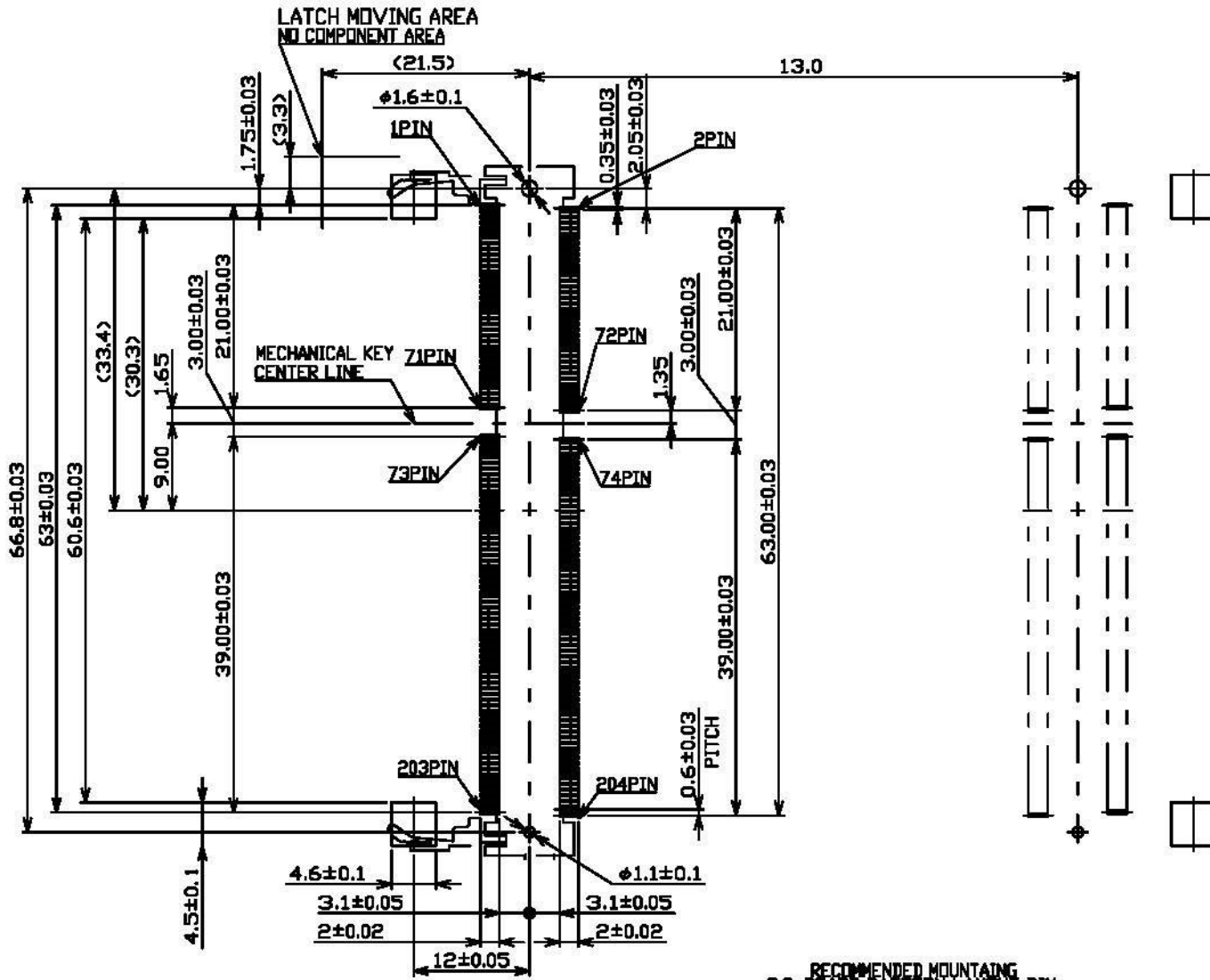

RECOMMENDED MOUNTING  
P.C. BOARD PATTERN LAYOUT DIM.

UNLESS OTHERWISE SPECIFIED TOLERANCE		
ANGLES	ANG.	±5°
LINEAR	0.	±0.3
	0.0	±0.25
	0.00	±0.20
SCALE	AS SHOWN	UNIT: mm
DRAWN	Willis	2012/12/05
CHECKED	Angel	2012/12/05
APPROVED	Ken	2012/12/05

**All Connectors**  
[www.allconnectors.de](http://www.allconnectors.de) | [info@allconnectors.de](mailto:info@allconnectors.de)  
 Tel: +49 375 411 10 10 | Fax: +49 375 411 10 10  
 +49 375 411 10 10 | [www.allconnectors.de](http://www.allconnectors.de)

**DRAWN NAME:** SO DIMM DDR3 Socket  
**1.5V 204Pin 4.0H Reverse Type**

**PRODUCT NO.:** 122A-40A10  
**FILE NAME:** 122A-40A10\_B\_1

REV.	DESCRIPTION	DATE	REV.	DESCRIPTION	DATE
1					
2					
3					
4					
5					
6					
7					
8					
9					
10					

△ Revise:  
 △ Revise:  
 △ Revise:



SIZE: A4  
 REV: 1.0



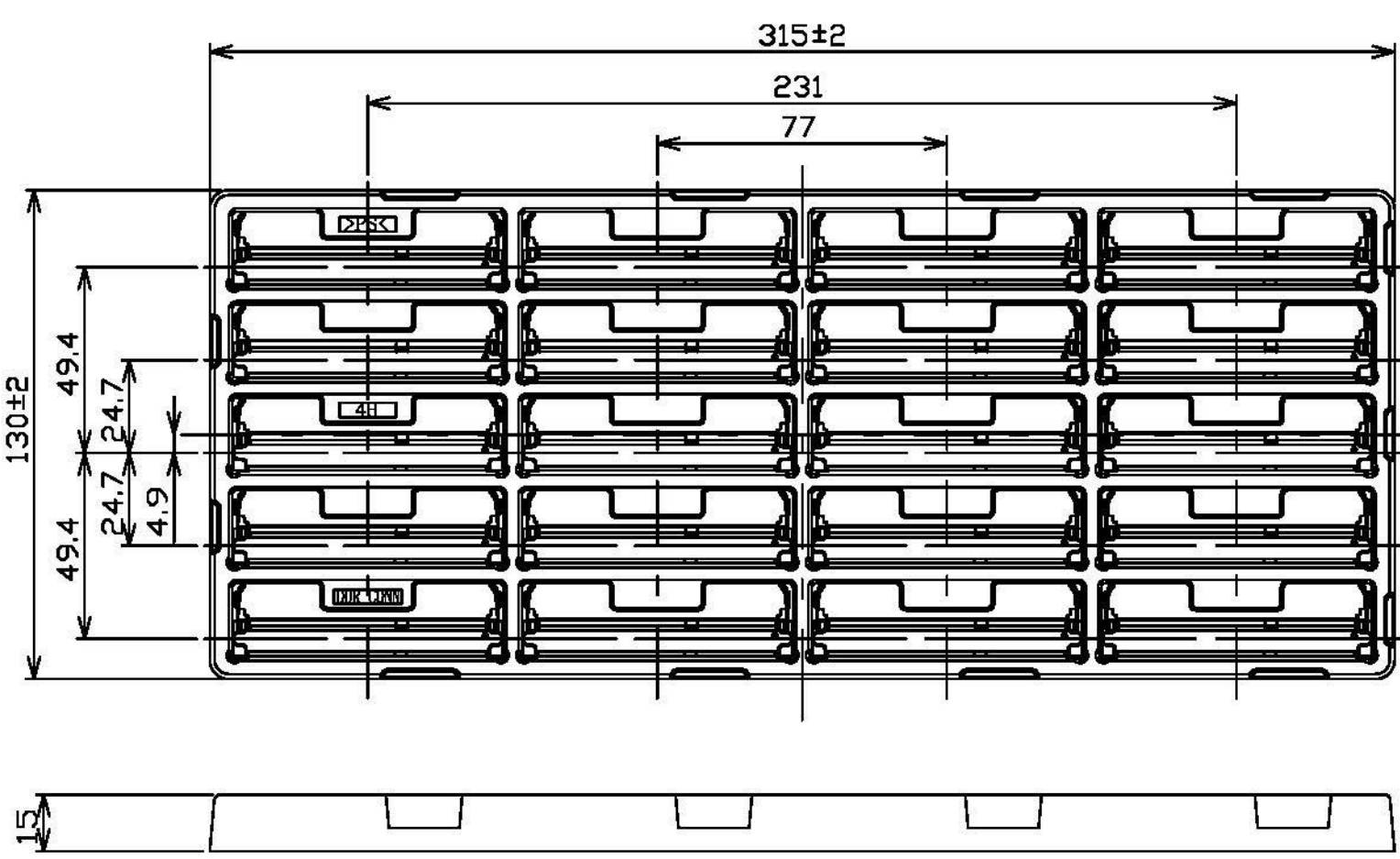

**PACKAGING SPECIFICATION:**

- 1. PACKING**
- 1.1 Quantity:**

  - 20 Piece/Tray**
  - 220 Piece/Inner Carton**
  - 660 Piece/Outer Carton**

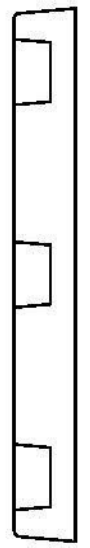

SOFT TRAY PACKAGING

						UNLESS OTHERWISE SPECIFIED TOLERANCE ANGLES    ANG.    ±SP LINEAR    0.0    ±0.25 0.00    ±0.20					
						SCALE	AS SHOWN	UNIT:	mm	www.allconnectors.de TEL: 0049 201 7090005 70729 Hildesheim - Germany info@allconnectors.de Fax: 0049 201 7090004 factsheet@ac.de	
						DRAWN	Willis	2012/12/05		DRAWN NAME:	SO DIMM DDR3 Socket
						CHECKED	Angel	2012/12/05		1.5V 204Pin 4.0H Reverse Type	
						APPROVED	Ken	2012/12/05		PRODUCT NO.	122A-40A10
REV.	DESCRIPTION		DATE	REV.	DESCRIPTION		DATE	SIZE	REV.	FILE NAME	
1				4				M	1.0	122A-40A10_D_1	

- △ Revise:
- △ Revise:
- △ Revise: