

Recommended PCB Layout (± 0.02)
PCB THICKNESS=1.60mm

- SPECIFICATIONS:**
- Electrical:
 - CURRENT RATING: 8A PER PIN MAX.
 - CURRENT VOLTAGE : 20V PER PIN MAX.
 - Contact Resistance: 30 milliohms MAX.
 - Dielectric Withstanding Voltage: 500V/AC.AT Sea Level.
 - Insulation Resistance: 500 MEGA ohms MIN.
 - Material:
 - Housing: High Temperature Thermoplastics. And Glass Fiber, UL94V-0 BLACK
 - Contact: Copper Alloy.
 - Shell: SPCC OR OTHER METAL
 - Finish:
 - Contact: Tin Plated Over Nickel.
 - Shell: Plating Nickel

DC X D - 028 X - X X X W
(1) (2)(3) (4) (5) (6)(7)

- SERIES NO.
DC: DC JACK
- CENTER HOLE DIAMETER
9: $\phi 1.65\text{mm}$
- PCB MOUNTING
D: DIP TYPE
- SCHEMATIC OPTION:
A: A TYPE B: B TYPE
- HOUSING MATERIAL
1: PBT 2: PA46 3: LCP
4: PA6T 5: PA9T
- COLOR
B: BLACK P: PINK
L: LIME
- CONTACT PLATING
1: GOLD PLATING
2: Tin PLATING

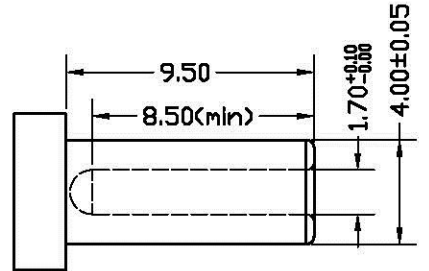

MATING PLUG

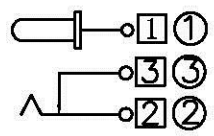

电路图示意图

5				DRAWING:	GENERAL TOLERANCE		 www.allconnectors.de Tel.: 0049 711 7095503 70794 Hilderstadt, Germany Info@allconnectors.de Fax: 0049 711 7095504 Kulmbacher Str. 25	
4				Match	.X: ± 0.30	.X': $\pm 2^\circ$		
3				CHECKED:	.XX: ± 0.20	.XX': $\pm 1^\circ$	DESCRIPTION: DC JACK CONNCTOR	
2				Foma	.XXX: ± 0.10	.XXX': $\pm 0.5^\circ$		
1				APPROVAL:	UNIT: MM	PROJECTION:	PART NO: DC9D-028A-3B2W REV: 1.0	
				Felix	SCALE: 1/1			
NO.	DATE	DESCRIPTION	APPROVAL		SHEET: 1/1			
1								