

Recommend Layout PCB.

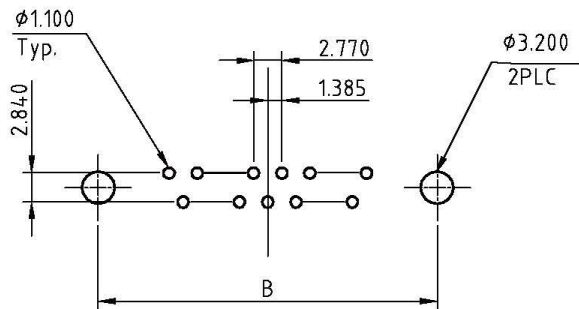

### ELECTRICAL CHARACTERISTICS

Contact Current Rating:3Amperes.  
 Dielectric Withstanding Voltage:AC 500V at sea level.  
 Insulation Resistance:1000Megohms Min.  
 Contact Resistance:30Milliohms Max.  
 Operation Temperature : -55°C to +105°C.

### Material

Contact :Copper Alloy.  
 Insulator:PBT.  
 Shell: SPCC.  
 Screw: Copper Alloy.  
 Boardlock: Copper Alloy

Note:

No.	A	B	C	D
09	16.33	24.99	30.81	19.23
15	24.66	33.32	39.14	27.56
25	38.38	47.04	53.04	41.28
37	54.84	63.50	69.32	57.33

**All Connectors**

www.allconnectors.de  
 Tel.: 0049 711 7009503  
 70794 Filderstadt - Germany

info@allconnectors.de  
 Fax: 0049 711 7009504  
 Kettenerstr. 25

**RoHS Compliant**

DRAWING BY CY  
 CHECKED BY GENIUS  
 UNIT/ mm SCALE 1:1  
 DATE  
 SIZE A4

TOLERANCES ARE

X ±  
 .X ± 0.30  
 .XX ± 0.25  
 .XXX ± 0.15  
 ANG ± 2°

PROJECTION



ORDER INFORMATION

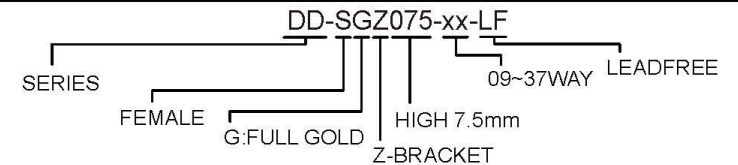

DESCRIPTION: D-SUB Female 180D- DIP