

ELECTRICAL CHARACTERISTICS

Contact Current Rating: 3 Amperes.
 Dielectric Withstanding Voltage: AC 500V at sea level.
 Insulation Resistance: 1000 Megohms Min.
 Contact Resistance: 30 Milliohms Max.
 Operation Temperature: -55°C to +105°C.

Material

Contact: Copper Alloy.
 Insulator: PBT.
 Shell: SPCC.
 Screw: Copper Alloy.
 Boardlock: Copper Alloy.

Recommend Layout PCB.

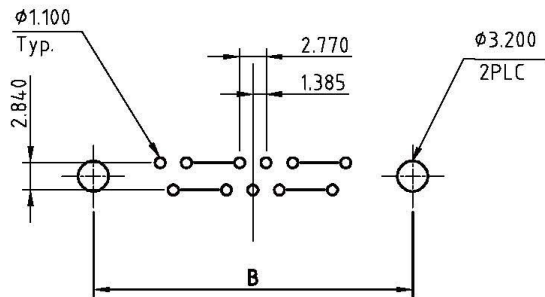

Note:

No.	A	B	C	D
09	16.92	24.99	30.81	19.23
15	25.25	33.32	39.14	27.56
25	38.96	47.04	53.04	41.28
37	55.42	63.50	69.32	57.33

All Connectors

www.allconnectors.de info@allconnectors.de
 Tel.: 0049 711 7009503 Fax: 0049 711 7009504
 70794 Filderstadt - Germany Kettenerstr. 25

RoHS Compliant

DRAWING BY CY
 CHECKED BY GENIUS
 UNIT/mm SCALE 1:1
 DATE
 SIZE A4 PROJECTION

TOLERANCES ARE

X ±
 .X ± 0.30
 .XX ± 0.25
 .XXX ± 0.15
 ANG ±



ORDER INFORMATION

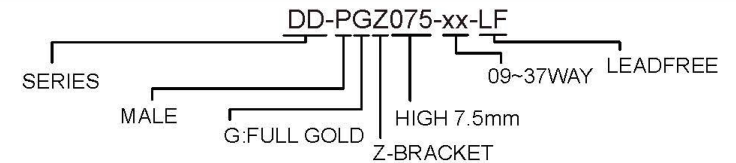

DESCRIPTION: D-SUB Male 180D- DIP