

THE INFORMATION CONTAINED IN THIS DOCUMENT IS PROPRIETARY TO Y-S ELECTRONIC, ANY REPRODUCTION IN PART OR WHOLE WITHOUT PRIOR WRITTEN APPROVAL OR AUTHORIZATION OF Y-S ELECTRONIC IS STRICTLY PROHIBITED.

RoHS COMPLIANT

REVISIONS				
REV	ECN NO.	DESCRIPTION	APPROVED BY	DATE

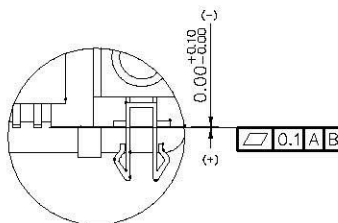
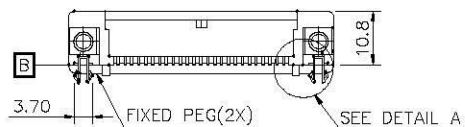
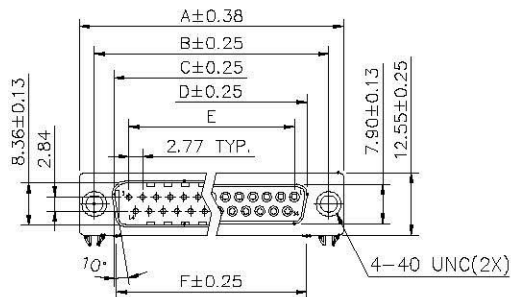

DETAIL A  
SCALE 3:1  
Snap-in boardlock

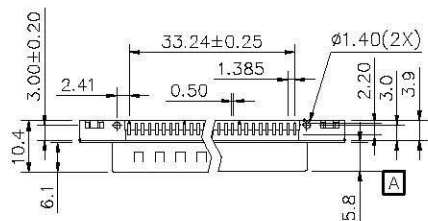

Dimensions

Positions	A	B	C	D	E	F
9	30.81	24.99	16.92	16.33	11.08	15.90
25	53.05	47.04	38.96	38.38	33.24	38.06

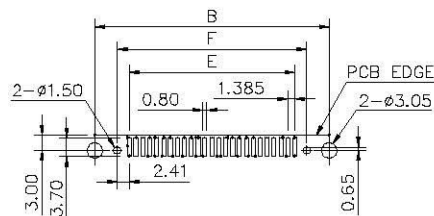

MALE PIN NUMBER:  
5 9 4 8 3 7 2 6 1

FEMALE PIN NUMBER:  
1 6 2 7 3 8 4 9 5

9 PIN RECOMMENDED PCB LAYOUT

MALE PIN NUMBER:  
13 25 12 24 11 23 10 22 9 21 8 20 7 19 6 18 5 17 + 16 3 15 2 14 1

FEMALE PIN NUMBER:  
1 14 2 15 3 16 4 17 5 18 6 19 7 20 8 21 9 22 10 23 11 24 12 25 13

25 PIN RECOMMENDED PCB LAYOUT

Product Specification

Material

Insulator :Glass-Filled Thermoplastic PBT,UL94V-0 rates  
Contact :Brass or Phosphor Bronze  
Shell : Steel, 100u" Tin Over 50u" min Copper  
Cinch Nut: Brass, 100u" min Nickel Plated.  
Boardlock :Brass, 100u" min Tin Plated.

Electrical

Contact Resistance :30 milliohms  
Max at 1 AMP DC.  
Insulation Resistance :1000  
megohms at 500 VDC  
Dielectric Withstanding Voltage :  
1000 VAC/rms 60Hz for 1 minute  
Current Rating :3 AMP  
Voltage Rating :250 VAC/rms 60Hz

Ordering Information

167 -  $\frac{XX}{a} \frac{X}{b} \frac{X}{c} \frac{X}{d} \frac{X}{e} \frac{X}{f} \frac{X}{g}$

- a. No. of Pins  
09: 09 positions  
25: 25 positions
- b. Contact Type  
1: Male  
2: Female
- c. Contact Plating  
0: gold flash selective gold  
1: 15u" selective gold on contact  
2: 30u" selective gold on contact
- d. Shell Plating  
1: Nickel(standard)  
2: Tin  
3: Dipped
- e. Insulator Color  
1: Blue  
2: Black (Standard)
- f. Rivetting Options:  
0: None  
1: Snap-in boardlock  
2: Press-in boardlock
- g. Flange Mounting Option  
0: Ø3.05mm clear hole  
1: #4-40 threaded hole with #4-40 unc screwlock installed  
2: #4-40 threaded hole with #4-40 unc screwlock bulk-packed  
3: #4-40 threaded hole

DO NOT SCALE DRAWING

DIMENSIONS: <input type="checkbox"/> MM [INCH] <input type="checkbox"/> INCH [mm] <input checked="" type="checkbox"/> MM ONLY	CAD GENERATED DRAWING, DO NOT MANUALLY UPDATE	
	DRAWN BY AND DATE JACK HONG 24-04-08	
UNLESS OTHERWISE SPECIFIED, GENERAL TOLERANCE: DECIMALS ANGLES .X ±0.38 [0.015] X° ±3° .X ±0.25 [0.010] .X° ±1.0° .XX ±0.13 [0.005]	CHECKED BY AND DATE JUSTIN XING 24-04-08 APPROVED BY AND DATE MICHAEL HUANG 24-04-08 THIRD ANGLE PROJECTION	TITLE 167 SERIES D-SUB SMT CONNECTOR
MATERIAL FINISH		DRAWING NO. 167-XXXXXX1X
SCALE: 1 : 1	SIZE: A3	REV A
FILE NO.:		SHEET 1 OF 1

THE INFORMATION CONTAINED IN THIS DOCUMENT IS PROPRIETARY TO Y-S ELECTRONIC, ANY REPRODUCTION IN PART OR WHOLE WITHOUT PRIOR WRITTEN APPROVAL OR AUTHORIZATION OF Y-S ELECTRONIC IS STRICTLY PROHIBITED.

RoHS COMPLIANT

REVISIONS				
REV	ECN NO.	DESCRIPTION	APPROVED BY	DATE

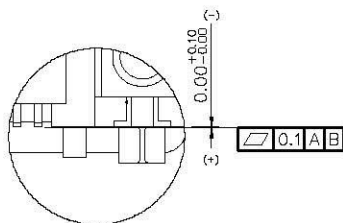
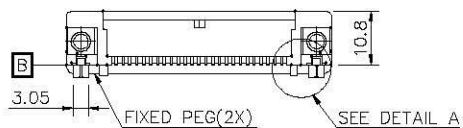
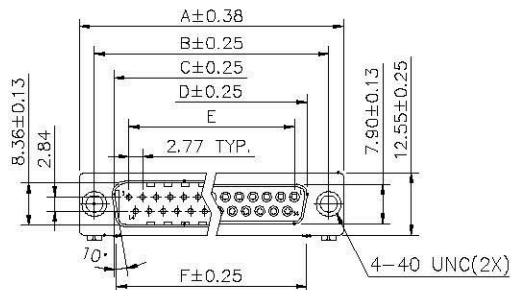

DETAIL A  
SCALE 3:1  
Press-in boardlock

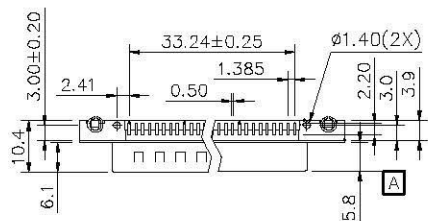

Dimensions

Positions	A	B	C	D	E	F
9	30.81	24.99	16.92	16.33	11.08	15.90
25	53.05	47.04	38.96	38.38	33.24	38.06

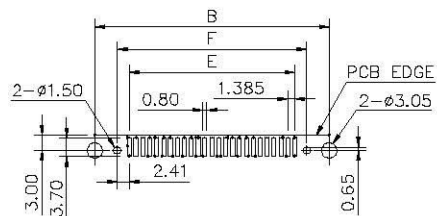

MALE PIN NUMBER:  
5 9 4 8 3 7 2 6 1

FEMALE PIN NUMBER:  
1 6 2 7 3 8 4 9 5

9 PIN RECOMMENDED PCB LAYOUT

MALE PIN NUMBER:  
13 25 12 24 11 23 10 22 9 21 8 20 7 19 6 18 5 17 4 16 3 15 2 14 1

FEMALE PIN NUMBER:  
1 14 2 15 3 16 4 17 5 18 6 19 7 20 8 21 9 22 10 23 11 24 12 25 13

25 PIN RECOMMENDED PCB LAYOUT

Product Specification

Material

Insulator :Glass-Filled Thermoplastic PBT,UL94V-0 rates  
Contact :Brass or Phosphor Bronze  
Shell : Steel, 100u" Tin Over 50u" min Copper  
Cinch Nut: Brass, 100u" min Nickel Plated.  
Boardlock :Brass, 100u" min Tin Plated.

Electrical

Contact Resistance :30 milliohms  
Max at 1 AMP DC.  
Insulation Resistance :1000  
megohms at 500 VDC  
Dielectric Withstanding Voltage :  
1000 VAC/rms 60Hz for 1 minute  
Current Rating :3 AMP  
Voltage Rating :250 VAC/rms 60Hz

Ordering Information

167 -  $\frac{XX}{a} \frac{X}{b} \frac{X}{c} \frac{X}{d} \frac{X}{e} \frac{X}{f} \frac{X}{g}$

- a. No. of Pins  
09: 09 positions  
25: 25 positions
- b. Contact Type  
1: Male  
2: Female
- c. Contact Plating  
0: gold flash selective gold  
1: 15u" selective gold on contact  
2: 30u" selective gold on contact
- d. Shell Plating  
1: Nickel(standard)  
2: Tin  
3: Dyanated
- e. Insulator Color  
1: Blue  
2: Black (Standard)
- f. Rivetting Options:  
0: None  
1: Snap-in boardlock  
2: Press-in boardlock
- g. Flange Mounting Option  
0: Ø3.05mm clear hole  
1: #4-40 threaded hole with #4-40 unc screwlock installed  
2: #4-40 threaded hole with #4-40 unc screwlock bulk-packed  
3: #4-40 threaded hole

DO NOT SCALE DRAWING

DIMENSIONS: <input type="checkbox"/> MM [INCH] <input type="checkbox"/> INCH [mm] <input checked="" type="checkbox"/> MM ONLY	CAD GENERATED DRAWING, DO NOT MANUALLY UPDATE  DRAWN BY AND DATE JACK HONG 24-04-08		
		<small>www.allconnectors.de Tel: 0049 211 7009200 70754 Hildersloh, Germany</small>	<small>info@allconnectors.de Fax: 0049 211 7009204 Katochenstr. 20</small>
UNLESS OTHERWISE SPECIFIED, GENERAL TOLERANCE: DECIMALS      ANGLES .X ±0.38 [0.015]    X° ±3° .XX ±0.25 [0.010]   X° ±1.0° .XX ±0.13 [0.005]	CHECKED BY AND DATE JUSTIN XING 24-04-08  APPROVED BY AND DATE MICHAEL HUANG 24-04-08  THIRD ANGLE PROJECTION 	TITLE  167 SERIES D-SUB SMT CONNECTOR	
MATERIAL  FINISH	SCALE: 1 : 1  SIZE: A3	DRAWING NO.  167-XXXXXX2X	REV A
FILE NO.:		SHEET 1 OF 1	