

THE INFORMATION CONTAINED IN THIS DOCUMENT IS PROPRIETARY TO Y-S ELECTRONIC, ANY REPRODUCTION IN PART OR WHOLE WITHOUT PRIOR WRITTEN APPROVAL OR AUTHORIZATION OF Y-S ELECTRONIC IS STRICTLY PROHIBITED.

RoHS COMPLIANT

REVISIONS

REV	ECN NO.	DESCRIPTION	APPROVED BY	DATE
G	▲	A0603471	KING CHIU	2006-03-28

CRIMP High feet male terminal

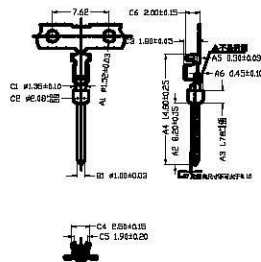

CRIMP Low feet male terminal

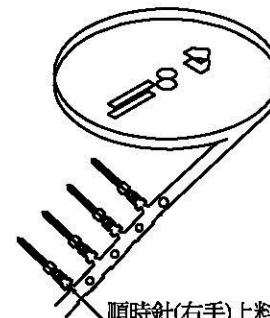
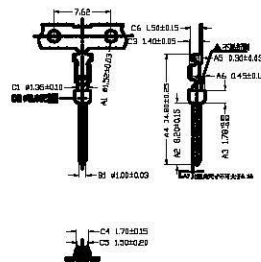

順時針(右手)上料

杯口朝內

clockwise (right hand feed)winding

CRIMP High feet female terminal

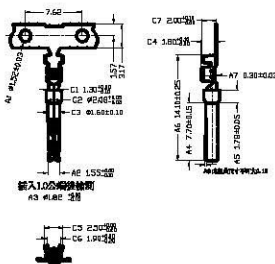

CRIMP Low feet female terminal

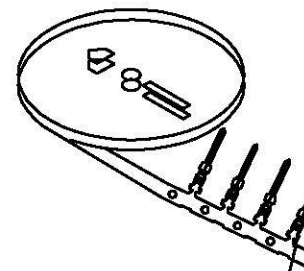
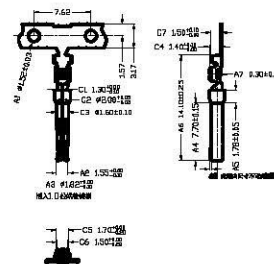

逆時針(左手)上料

杯口朝內

counter clockwise(left hand feed) winding

102 TERMINAL SERIES CRIMP TYPE
Ordering Information

Series No: 102 - [] [] [] [] [] []

Contact Type:
1: Male
2: Female

Contact Plating:
1: UNPLATED
2: GOLD PLATED 1U"
3: GOLD PLATED 15U"
4: GOLD PLATED 30U"
5: FULL GOLD 1U"
6: FULL GOLD 15U"
7: FULL GOLD 30U"
8: GOLD PLATED 50U"
9: PURE COPPER 1/2, MATERIAL
A: PURE COPPER 1/2, GOLD PLATED 1U"
B: PURE COPPER 1/2, GOLD PLATED 15U"
C: PURE COPPER 1/2, GOLD PLATED 30U"
D: PURE COPPER 1/2, FULL GOLD 1U"
E: PURE COPPER 1/2, FULL GOLD 15U"
F: PURE COPPER 1/2, FULL GOLD 30U"
G: GOLD PLATED 50U"

Going-up Direction:
L: left hand going-up Direction
R: right hand going-up Direction
W: waight direction

Apply bound:
1. Apply 20-24AWG(high)
2. Apply 24-28AWG(low)

OUTPUT TRAY TYPE:
1. 15K/per reel
2. 10K/per reel
3. 2K/per reel
4. 100PCS/COIL
5. 100PCS/ PE BA

- NOTE:
1. Crimp, counterclockwise(left hand feed)winding, clockwise. (right hand feed)winding.
2. Use the white foam rubber 030 stick(hengfeng brand) to gather the acetic acid ethylene lotion styrafoam and cardboard.
3. No transparent tape is allowed to upper and lower cardboard.

DO NOT SCALE DRAWING

NO	PART NO.	DESCRIPTION	QTY	UNIT
10		CARDBOARD=11.5*10.7CM (inside covers)(A3A)	2/400	PCS
9		PE BAG 4" * 4" * 0.06MM	1/100	PCS
8		CARTON IN=22*30.5*20CM (A3A) 100PCS PACKING	XX/K	PCS
7		CARTON=46.5*35*22.5CM (nothing any painting) 400PCS OR 100PCS PACKING	XX/K	PCS
6		CARDBOARD=50*10.6CM (K=K)	2/10K	PCS
5		CARTON IN=51*51*29CM (K=K) 10K PACKING	1/8	TRAY
4		STYROFOAM: =4.5*10.7(inside covers)*2.3CM	1	PCS
3		CARDBOARD=37*10.6CM (K=K)	2/3K	PCS
2		CARTON=38*38*36CM (K=K) 2K PACKING	1/10	TRAY
1		TERMINAL Crimp=1.0mm XX	1/3K	TRAY

DIMENSIONS:
 MM (INCH) INCH [mm] MM ONLY

UNLESS OTHERWISE SPECIFIED, GENERAL TOLERANCE:
 DECIMALS: X: ±0.38 [0.015] X*: ±3°
 .X: ±0.25 [0.010] .X*: ±1.0°
 .XX: ±0.13 [0.005]

MATERIAL:
FINISH:

CAD GENERATED DRAWING, DO NOT MANUALLY UPDATE

DRAWN BY AND DATE
JUSTIN XING 08-23-04

CHECKED BY AND DATE
JUSTIN XING 08-23-04

APPROVED BY AND DATE
KING CHIU 08-23-04

THIRD ANGLE PROJECTION

SCALE: NONE SIZE: A3

All Connectors

www.allconnectors.de
Tel: +49 44 31 204404
72794 Filderstadt, Germany

info@allconnectors.de
Tel: +49 44 31 204434
Kollmuthstraße 25

TITLE
102 SERIES
I-SUB CRIMP TERMINAL

DRAWING NO. 102-XXXXX

REV G

FILE NO. SHEET 1 OF 1