

THE INFORMATION CONTAINED IN THIS DOCUMENT IS PROPRIETARY TO Y-S ELECTRONIC, ANY REPRODUCTION IN PART OR WHOLE WITHOUT PRIOR WRITTEN APPROVAL OR AUTHORIZATION OF Y-S ELECTRONIC IS STRICTLY PROHIBITED.

RoHS COMPLIANT

REVISIONS				
REV	ECN NO.	DESCRIPTION	APPROVED BY	DATE

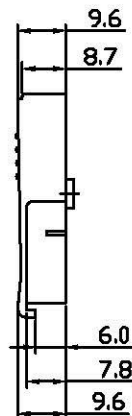
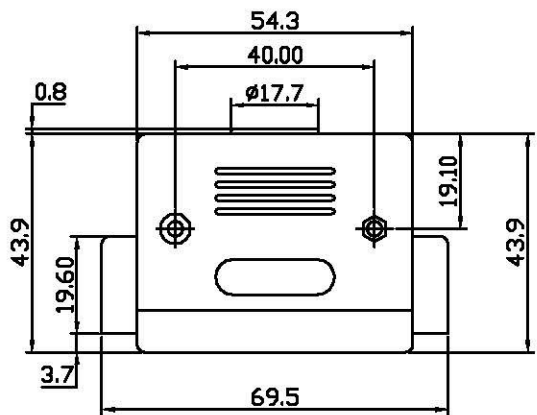

Product Specification

Material

- Hood :ABS thermoplastic UL94V-0 rates
- UL94V-0 rates
- Screwlock :Steel, 100u" min Nickel Plated.

Ordering Information

$$156 - \frac{XX}{a} \frac{X}{b} \frac{X}{c} \frac{X}{d}$$

- a. No. Of Pins
- b. Shell Type
 - 0: Plastic
 - 1: Nickel plate metallized
- c. Screw Type
 - 1: Short screws with #4-40 unc
 - 2: Long screws with #4-40 unc
 - 3: Short screws with M3
 - 4: Long screws with M3
- d. Insulator Color
 - 1: Black
 - 2: Gray
 - 3: Platinum

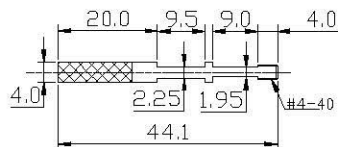
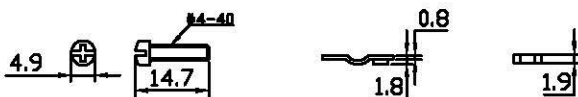
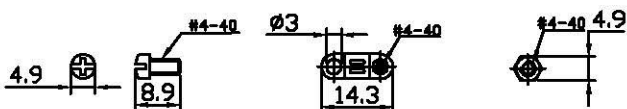
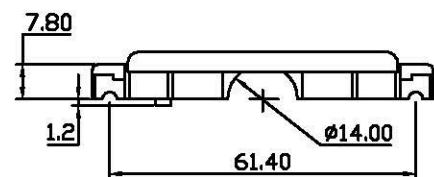

Long Screw type
50pin type only

DO NOT SCALE DRAWING

DIMENSIONS: <input type="checkbox"/> MM (INCH) <input type="checkbox"/> INCH (mm) <input checked="" type="checkbox"/> MM ONLY	CAD GENERATED DRAWING, DO NOT MANUALLY UPDATE DRAWN BY AND DATE JUSTIN XING 07-03-06			
		www.allconnectors.de info@allconnectors.de Tel: 0049 711 7000902 Fax: 0049 711 7000904 Al/19 Hilberstr. Germany kernconnectors.de		
UNLESS OTHERWISE SPECIFIED, GENERAL TOLERANCE: DECIMALS ANGLES .X: ±0.38 [0.015] X°: ±3° .X: ±0.25 [0.010] .X°: ±1.0° .XX: ±0.13 [0.005]	CHECKED BY AND DATE JUSTIN XING 07-03-06 APPROVED BY AND DATE KING CHIU 07-03-06 THIRD ANGLE PROJECTION	TITLE 156 SERIES D-SUB COVER		
		MATERIAL		DRAWING NO. 156-50X2X
FINISH	SCALE: 1 : 1	SIZE: A3	FILE NO.:	SHEET 10 OF 10