

THE INFORMATION CONTAINED IN THIS DOCUMENT IS PROPRIETARY TO Y-S ELECTRONIC, ANY REPRODUCTION IN PART OR WHOLE WITHOUT PRIOR WRITTEN APPROVAL OR AUTHORIZATION OF Y-S ELECTRONIC IS STRICTLY PROHIBITED.

RoHS COMPLIANT

REVISIONS				
REV	ECN NO.	DESCRIPTION	APPROVED BY	DATE
A				2005-10-27

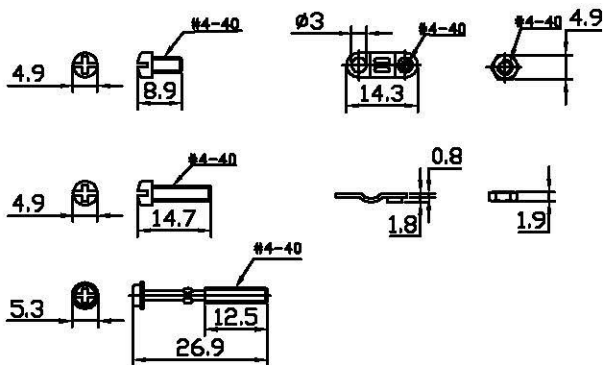
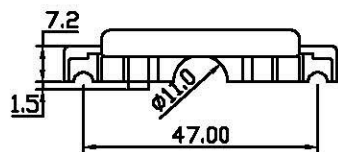
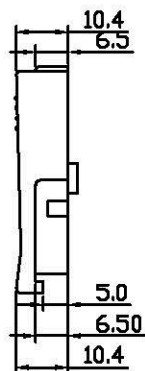
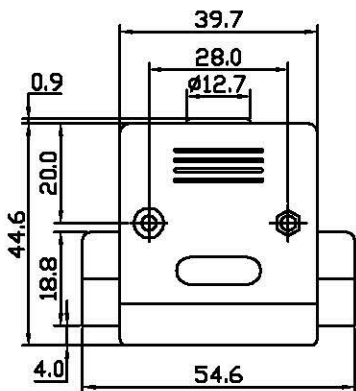

Short Screw type
25pin type only

Product Specification

Material

- Hood :ABS thermoplastic UL94V-0 rates
- UL94V-0 rates
- Screwlock :Steel, 100u" min Nickel Plated.

Ordering Information

$$156 - \frac{XX}{a} \frac{X}{b} \frac{X}{c} \frac{X}{d}$$

- a. No. Of Pins
- b. Shell Type
 - 0: Plastic
 - 1: Nickel plate metallized
- c. Screw Type
 - 1: Short screws with #4-40 unc
 - 2: Long screws with #4-40 unc
 - 3: Short screws with M3
 - 4: Long screws with M3
- d. Insulator Color
 - 1: Black
 - 2: Gray
 - 3: Platinum

DO NOT SCALE DRAWING

DIMENSIONS: <input type="checkbox"/> MM [INCH] <input type="checkbox"/> INCH [mm] <input checked="" type="checkbox"/> MM ONLY		CAD GENERATED DRAWING, DO NOT MANUALLY UPDATE			
UNLESS OTHERWISE SPECIFIED, GENERAL TOLERANCE: DECIMALS ANGLES .X: ±0.38 [0.015] X°: ±3° .X: ±0.25 [0.010] .X°: ±1.0° .XX: ±0.13 [0.005]		CHECKED BY AND DATE JUSTIN XING 07-03-06		TITLE 156 SERIES D-SUB COVER	
MATERIAL		APPROVED BY AND DATE KING CHIU 07-03-06		DRAWING NO. 156-25X1X	
FINISH		THIRD ANGLE PROJECTION		REV A	
SCALE: 1 : 1		SIZE: A3		FILE NO.: SHEET 3 OF 10	