

THE INFORMATION CONTAINED IN THIS DOCUMENT IS PROPRIETARY TO Y-S ELECTRONIC, ANY REPRODUCTION IN PART OR WHOLE WITHOUT PRIOR WRITTEN APPROVAL OR AUTHORIZATION OF Y-S ELECTRONIC IS STRICTLY PROHIBITED.

RoHS COMPLIANT

REVISIONS				
REV	ECN NO.	DESCRIPTION	APPROVED BY	DATE

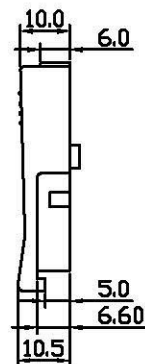
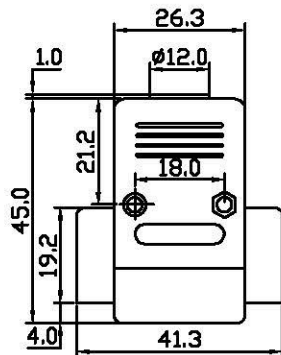

Product Specification

Material

Hood :ABS thermoplastic UL94V-0 rates  
 UL94V-0 rates  
 Screwlock :Steel, 100u" min Nickel Plated.

Ordering Information

156 -  $\frac{XX}{a} \frac{X}{b} \frac{X}{c} \frac{X}{d}$

- a. No. Of Pins
- b. Shell Type
  - 0: Plastic
  - 1: Nickel plate metallized
- c. Screw Type
  - 1: Short screws with #4-40 unc
  - 2: Long screws with #4-40 unc
  - 3: Short screws with M3
  - 4: Long screws with M3
- d. Insulator Color
  - 1: Black
  - 2: Gray
  - 3: Platinum

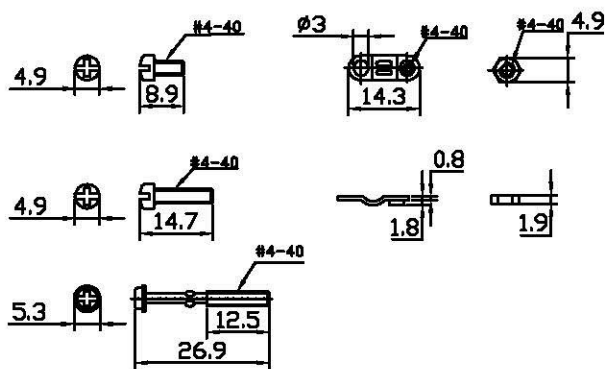
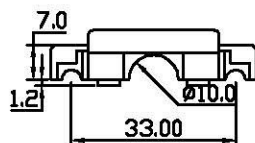

Short Screw type  
 15pin type only

DO NOT SCALE DRAWING

DIMENSIONS: <input type="checkbox"/> MM (INCH) <input type="checkbox"/> INCH (mm) <input checked="" type="checkbox"/> MM ONLY	CAD GENERATED DRAWING, DO NOT MANUALLY UPDATE DRAWN BY AND DATE JUSTIN XING 07-03-06	<b>All Connectors</b> <small>www.allconnectors.de   info@allconnectors.de          Tel.: 0646 711 7006209   Fax: 0646 711 7006204          70754 Ulmerstadt - Germany   keller@msl.de</small>	
		CHECKED BY AND DATE JUSTIN XING 07-03-06 APPROVED BY AND DATE KING CHIU 07-03-06 THIRD ANGLE PROJECTION	
UNLESS OTHERWISE SPECIFIED, GENERAL TOLERANCE: DECIMALS: X: ±0.38 [0.015] X*: ±3° .X: ±0.25 [0.010] .X*: ±10° .XX: ±0.13 [0.005]	MATERIAL:	TITLE 156 SERIES D-SUB COVER	
FINISH:	SCALE: 1 : 1	SIZE: A3	DRAWING NO. 156-15X1X FILE NO. SHEET 2 OF 10