

### ELECTRICAL CHARACTERISTICS

Contact Current Rating: 1 Amperes.  
 Dielectric Withstanding Voltage: AC 500V at sea level.  
 Insulation Resistance: 1000 Megohms Min.  
 Contact Resistance: 30 Milliohms Max.  
 Operation Temperature: -55°C to +105°C.

### Material

Contact: Copper Alloy.  
 Insulator: LCP. (Select PA6T / PA9T)  
 Shell: SPCC.  
 Z-Piece: Copper Alloy.

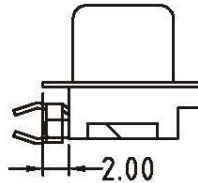
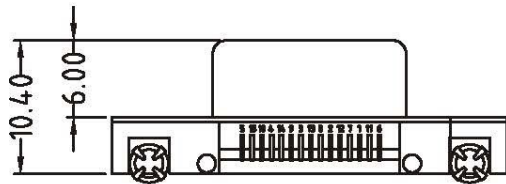

HDW-SNZ4-15-LF  
 LEADFREE  
 RoHS Compliant

### RECOMMEND PCB LAYOUT

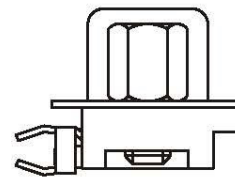
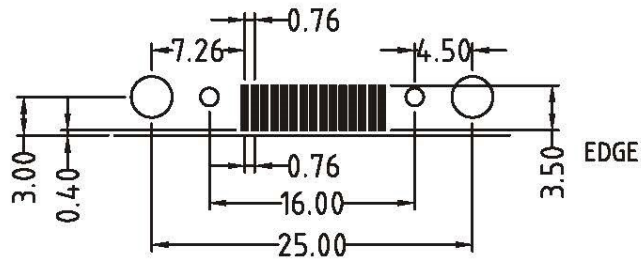

HDW-SNJZ4-15

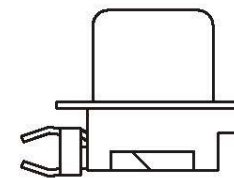

HDW-SNHZ4-15

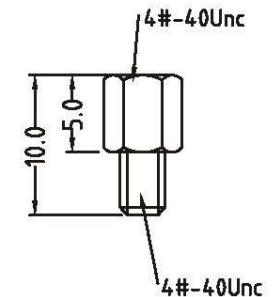

**Allconnectors**

www.allconnectors.de  
 Tel.: 0049 711 7009903  
 20794 Filderstadt - Germany

info@allconnectors.de  
 Fax: 0049 711 7009904  
 Kettnerstr. 25

PART NO. HDW-SNZ4-15

DWG NO. HDW-SNZ4-15

CHECKED BY CY

TOLERANCES ARE

DESCRIPTION:

FILE NO.

DRAWING BY

.X ± 0.2  
 .XX ±  
 .XXX ±  
 AWG

AREA

REVISIONS

HK

DATE

UNIT / mm

SCALE 1:1

PROJECTION

