

1	2	3	4	5	6	7	8	9	10
SWITCH CIRCUIT			MATERIAL AND FINISH AS BELOW						
WHEN CARD IS EJECTED		WHEN CARD IS INSERTED		A	Housing	LCP UL94V-0 Black	E		
				B	Contact	Phosphor Bronze C5210, 0.2t, 10u" Gold	F		
				C	Shell	Stainless Steel SUS304, 0.2t	G		
				D	Hold down	Brass C2680, 0.2t, Tin Plating	H		

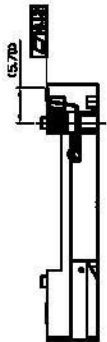

Section view A-A

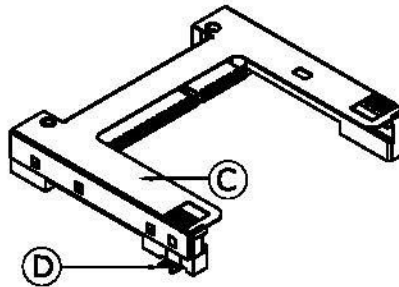
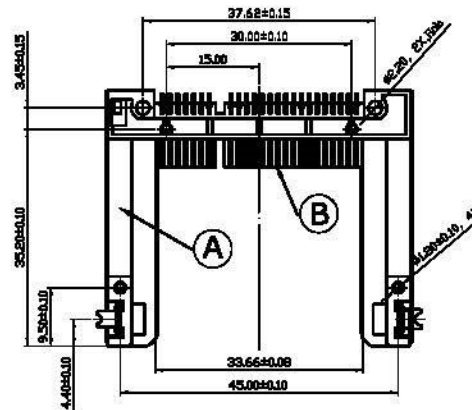
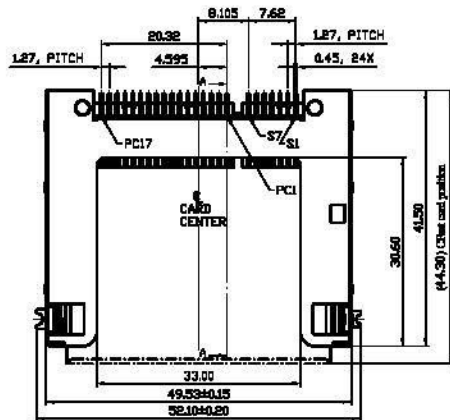

SPECIFICATION:

1. ELECTRICAL

- 1.1 Current Rating: 1.5A
- 1.2 Voltage Rating: 100V AC/DC
- 1.3 Contact Resistance: 30mΩ
- 1.4 Insulation Resistance: 1000MΩ
- 1.5 Dielectric Withstanding Voltage: 500VDC

2. MECHANICAL

- 2.1 Durability: 10000 Cycle
- 2.2 Insertion Force: 28.8N max.
- 2.3 Extraction Force: 3.7~24.5N max.

3. ENVIRONMENTAL

- 3.1 Operating temperature range: -40°C~+85°C
- 3.2 Storage temperature range: -40°C~+85°C

4. SOLDER ABILITY

- 4.1 Recommended IR Reflow Temperature: 260°C

P1	P2	P3	P4	P5	P6	P7	P8	P9	P10	P11	P12
----	----	----	----	----	----	----	----	----	-----	-----	-----

PIN ASSIGNMENT

120A-835D00 Height 8.35 Type II, Contact area 10u" Gold Plating

PRODUCT NO. DESCRIPTION

UNLESS OTHERWISE SPECIFIED TOLERANCE

ANGLES	ANG.	±5°
	0.	±0.3
LINEAR	0.0	±0.25
	0.00	±0.20

SCALE AS SHOWN UNIT: mm

DRAWN Willis 2013/05/07

CHECKED Angel 2013/05/07

APPROVED Ken 2013/05/07



www.allconnectors.com
Tel: 1075 40 0000
1074 Riverside Parkway
Kilburn, NJ 08049

Info@allconnectors.com
Fax: 1075 40 0000
Kilburn, NJ

DRAWN NAME: CFAST Socket 8.35H Type II

PRODUCT NO. 120A-835D00
FILE NAME 120A-835D00_B_2

REV.	DESCRIPTION	DATE	REV.	DESCRIPTION	DATE	SIZE A4	REV. 1.0
1			4				
2			5				
3			6				
7			8				
9			10				

