

SPECIFICATION:

A=SL002

B=MATERIAL:Spring Brass

Thickness:0.4t

C=Fuse \varnothing 5x20mm 250V AC 10A Max

D=Bright Tin-Plated, Nickel-Plated

E=P.C. Board Type with Fuse Stops

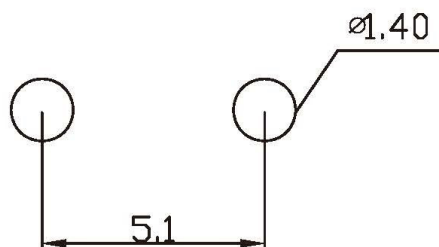
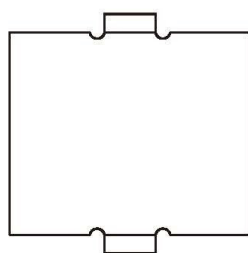

All Connectors

www.allconnectors.de info@allconnectors.de
Tel.: 0049 711 7009503 Fax: 0049 711 7009504
70794 Filderstadt - Germany Kettnerstr. 25

RoHS Compliant

DRAWING BY CY
CHECKED BY GENIUS
UNIT/ mm SCALE 1 : 1
DATE
SIZE A4

TOLERANCES ARE

X ±
.X ±
.XX ±
.XXX ±
ANG ±

P PROJECTION



ORDER INFORMATION

FSC-D-5X20-LF
SERIES | LEADFREE
5X20mm
DIP 180°

DESCRIPTION: