

REV.	DESCRIPTION	ECN NO.	DATE	DRAWER
C	Modified by Customer Design	EC0601010	01/05/2006	Edsen
D	Added Plating Option	EC0706032	06/20/2007	Kelly
E	Added Forklock Option \triangle x4	EC0803049	03/21/2008	Sherry

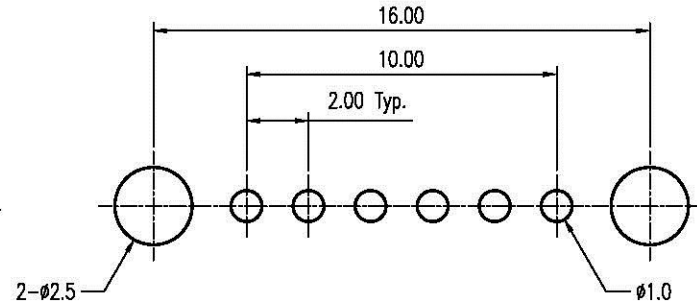
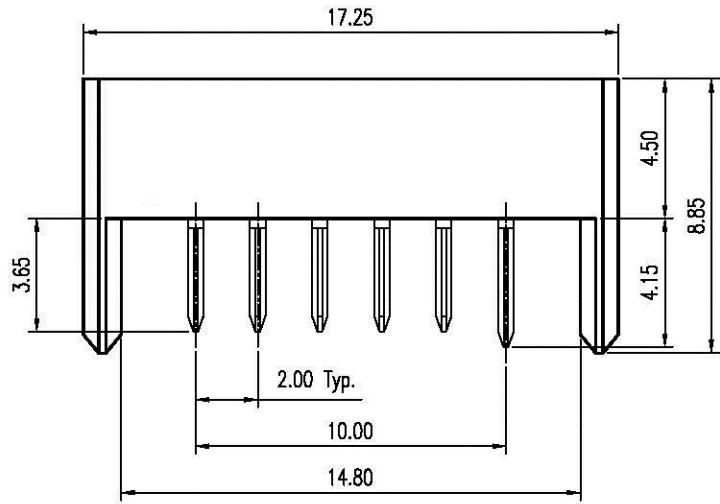

Recommended P.C.B. Layout
Layout Tolerance = ± 0.05 mm

Notes:

- Material :
Housing : Thermoplastic UL 94V-0, Black
Terminal : Copper Alloy
Forklock : Copper Alloy
- Finish :
Terminal : Selected Gold on Contact Area, G/F on Solder Tails, Both over 50u" Min. Ni Under-plated Overall
Forklock : G/F Overall
- Order Information :
SA1-03106- X OT X
T : RoHS (High Temperature)
Forklock Option:
0 : With Forklock
1 : Without Forklock
Plating Option:
2 : 2u" Min. Gold on Contact Area
3 : 5u" Min. Gold on Contact Area
4 : 10u" Min. Gold on Contact Area

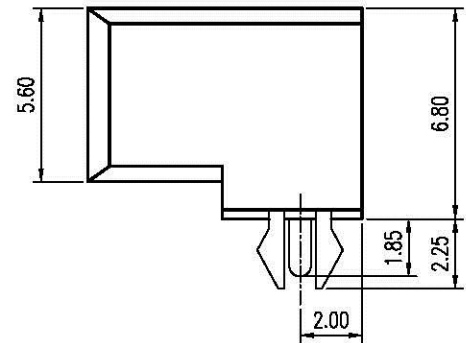
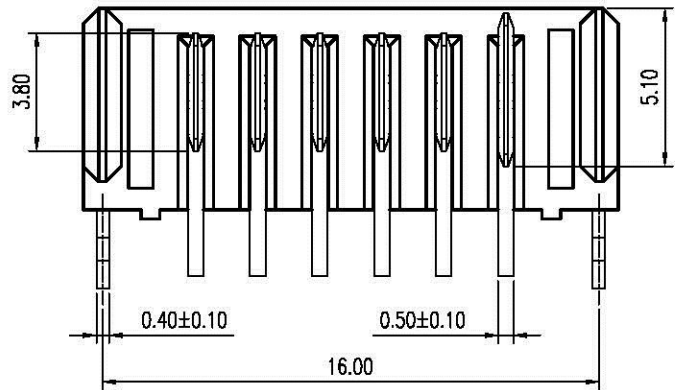

\triangle TSA1-03106-00TX
With Forklock

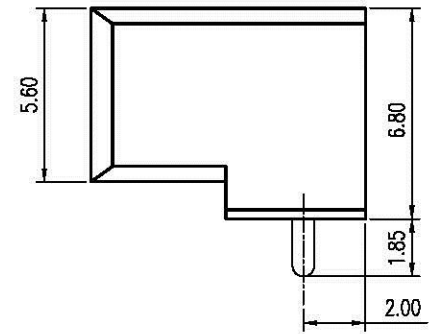

\triangle TSA1-03106-10TX
Without Forklock

DIMENSION IN mm [inch]		All Connectors www.allconnectors.de Tel: 0345 211 2000/03 Jahresstraße 12 0345 211 2000/04 Rechenstraße 2	Title 2.0mm Pitch Battery Conn. Male R/A Type		Scale: 4 : 1
Tolerance unless otherwise specified			Dwg No. TSA1-03106-X0TX \triangle	File No. PO2014	
X.	X.' $\pm 10'$	CUSTOMER DRAWING	Appraver:		Rev : E
X.X ± 0.38	X.X' $\pm 5'$		Checker:		Sheet: 1 / 1
X.XX ± 0.25	X.XX' $\pm 2'$		Drawer: Sherry		
X.XXX ± 0.13	X.XXX' \pm		03/21/2008		