

Signal Segment	
Name	Type
S1	GND
S2	A+
S3	A-
S4	GND
S5	B-
S6	B+
S7	GND

Power Segment	
Name	Type
P1	V33
P2	V33
P3	V33
P4	GND
P5	GND
P6	GND
P7	V5
P8	V5
P9	V5
P10	GND
P11	DAS/DSS
P12	GND
P13	V12
P14	V12
P15	V12

NOTES:

1. Material:

Housing: LCP+50%G.F, UL 94V-0 rated.
 Color: Black.
 Contact: Brass.
 Plating: Gold plating over Nickel(40~80u") on contact area; Tin plating(100~250u") on solder tail.
 Harpoon: Brass.
 Plating: Tin plating(100~250u") over Nickel(40~80u").

2. Mechanical:

Insertion Force: 45N max.
 Withdrawal Force: 10N min.
 Durability: 500 cycles

3. Electrical Specification:

Current Rating: 1.5 Ampere per contact;
 Contact Resistance: 30mΩ max.
 Insulation Resistance: 1000MΩ min.
 Dielectric Withstanding Voltage: 500 V AC.

4. Environmental:

Operating Temperature: -55°C to +85°C

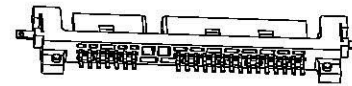
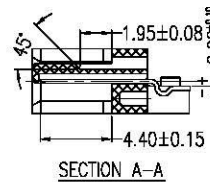
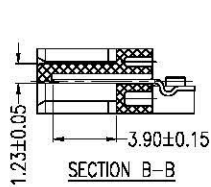
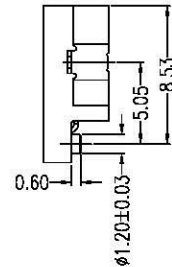

Part Number:

CSAT-M221S 30-R7

Serial ATA Series
 M: Male Type
 22: 7+15Pins
 1: Subside Type

R7: Reverse Subside Type
 S: Standard Type
 0: Black Color
 3: 15u" Plating
 S: SMT Type

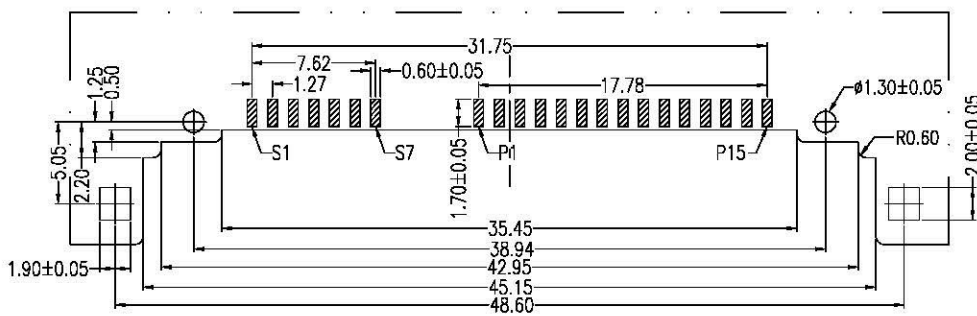

PCB LAYOUT(T=1.60)
 COMPONENT SIDE

A	05/18/10	RELEASED FOR PRODUCTION		DESCRIPTION	
REV	DATE				
UNLESS OTHERWISE SPECIFIED DIMENSIONS ARE IN MM TOLERANCES ARE:		CAD GENERATED DRAWING, DO NOT MANUALLY UPDATE			
DECIMALS	ANGLES	APPROVALS	DATE		
X ± .38	± 3°	DRAWN	05/18/10	Tel: 0049 711 7009208	Fax: 0049 711 7009204
.XX ± .25		CHECKED	05/18/10	20791 Filderstadt - Germany	
.XXX ± .20		APPV	05/18/10	DESCRIPTION	
DO NOT SCALE DRAWING		SHEET	SCALE	DWG. NO.	REV.
		1 OF 1	NONE	CSAT-M22-0C7	A