

Signal Segment	
Name	Type
S1	GND
S2	A+
S3	A-
S4	GND
S5	B-
S6	B+
S7	GND

Power Segment			
Name	Type	Name	Type
P1	V33	P9	V5
P2	V33	P10	GND
P3	V33	P11	DAS/DSS
P4	GND	P12	GND
P5	GND	P13	V12
P6	GND	P14	V12
P7	V5	P15	V12
P8	V5		

**NOTES:**

**1. Material:**

Housing: LCP+50%G.F, UL 94V-0 Rated.  
 Color: Black.  
 Contact: Phosphor Bronze.  
 Plating: Gold Plating over Nickel on Contact Area.  
 Tin Plating on Solder Tail.  
 Harpoon: Brass.  
 Plating: Tin Plating over Nickel.

**2. Mechanical:**

Insertion Force: 45N Max.  
 Withdrawal Force: 10N Min.  
 Durability: 500 Cycles

**3. Electrical Specification:**

Operation Voltage: 100VAC Max.  
 Current Rating: 1.5 Ampere per Contact.  
 Contact Resistance: 30mΩ Max.  
 Insulation Resistance: 1000MΩ Min.  
 Dielectric Withstanding Voltage: 500 VAC.

**4. Environmental:**

Operating Temperature: -55°C to +85°C

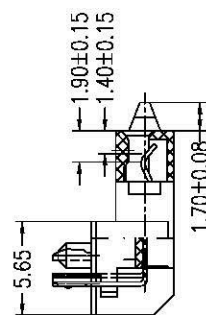
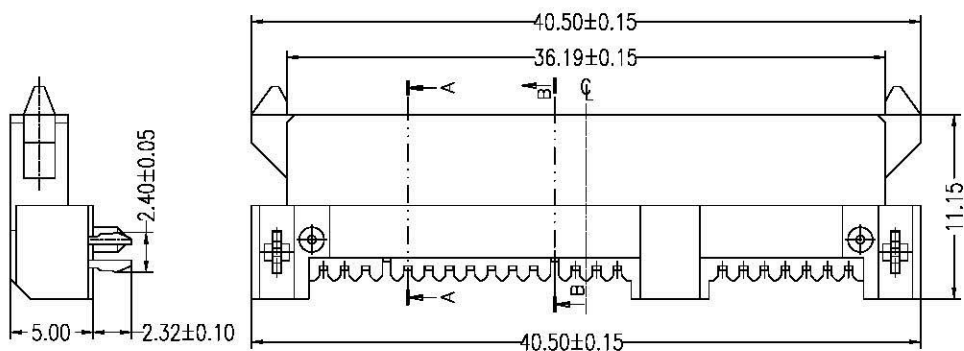

SECT A-A

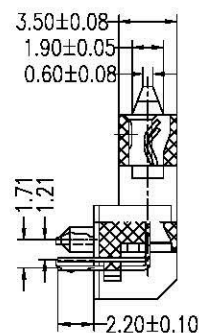

SECT B-B

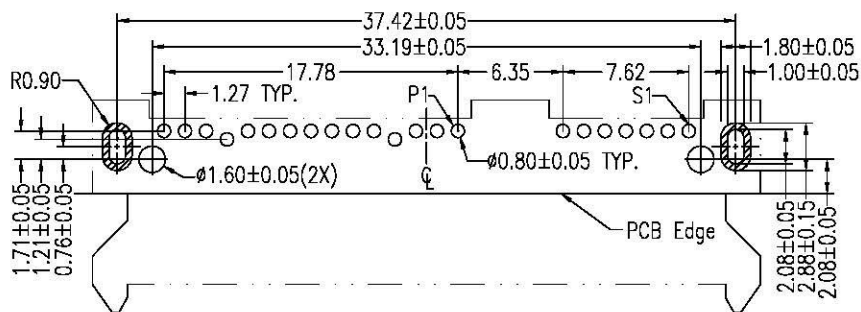

P.C.B LAYOUT(T=1.6mm)  
COMPONENT SIDE

**Part Number:**

**CSAT-F22RD30-R3**

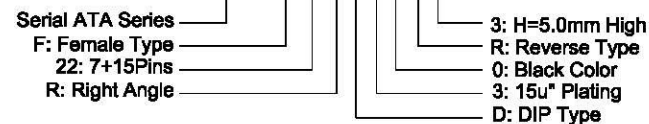

A	09/23/10	RELEASED FOR PRODUCTION		DESCRIPTION	
REV	DATE				
UNLESS OTHERWISE SPECIFIED, DIMENSIONS ARE IN MM. TOLERANCES ARE:		CAD GENERATED DRAWING, DO NOT MANUALLY UPDATE			
DECIMALS	ANGLES	APPROVALS	DATE		
X ± .38	± 3°	DRAWN	Chris	09/23/10	info@allconnectors.de Fax: 0049 711 7009504 Kettnerstr. 25
.XX ± .25		CHECKED	Chndy	09/23/10	<b>Serial ATA 7+15P Female, Right Angle Reverse Type, DIP, H:5.0mm</b>
.XXX ± .20		APPV	Jason	09/23/10	
DO NOT SCALE DRAWING		SHEET	1 OF 1	SCALE	DWG. NO.
				NONE	<b>CSAT-F22-B0A</b>